

K-SV 6 3

Bulkhead connectors

HANSA FLEX

Caratteristiche

Pressione di lavoro Max. 18 bar

Materiale di tenuta Buna-N

Materiale Ottone nichelato

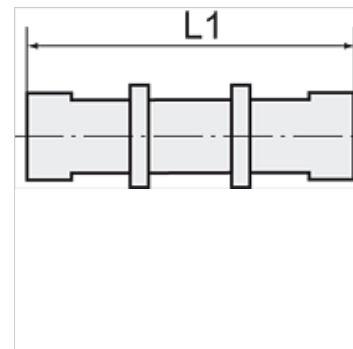
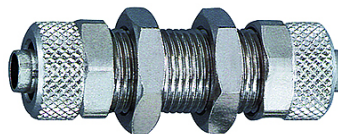

Nota

Altri dati su richiesta.

Articolo

Denominazione	Filetto	per flessibile	L1 (mm)	SW
K- 07 40 31 24	M 7 x 0.75	5 mm / 3 mm	40,0	9 mm
K- 07 40 31 25	M 10 x 1	6 mm / 4 mm	47,0	14 mm
K- 07 40 31 26	M 12 x 1	8 mm / 6 mm	48,0	16 mm
K- 07 40 31 22	M 14 x 1	10 mm / 8 mm	49,0	17 mm
K- 07 40 31 23	M 16 x 1	12 mm / 10 mm	53,0	19 mm