

K-MUFFEN SK MS NI

Sockets with outer hex - nickel-plated brass

Caratteristiche

Temperatura d'esercizio	Max. 150 °C
Pressione	Max. 60 bar
Materiale	Ottone nichelato

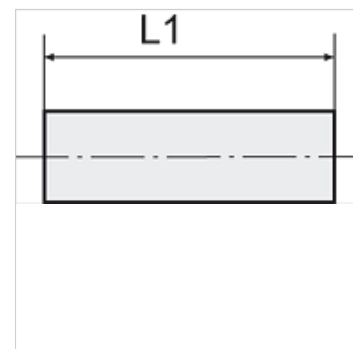
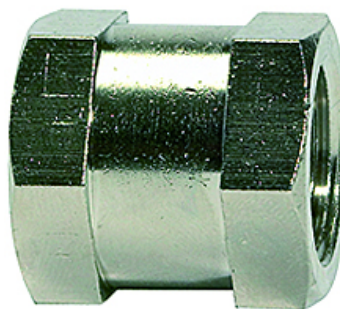

Nota

The dimensions of the standard screw fittings may change slightly during the life of the catalogue as a result of optimisation processes.
Altri dati su richiesta.

Descrizione

Suitable for air, water, oil, steam, etc.

Informazioni supplementari

Further types and dimensions on request.

Articolo

Denominazione	Filetto	L1 (mm)	SW
K- 07 40 15 06	M 5	11,0	8 mm
K- 07 40 15 07	G 1/8	15,0	14 mm
K- 07 40 15 08	G 1/4	22,0	17 mm
K- 07 40 15 09	G 3/8	24,0	22 mm
K- 07 40 15 11	G 1/2	30,0	27 mm
K- 07 40 15 10	G 3/4	32,0	32 mm
K- 07 40 15 12	G 1	35,0	38 mm