

# K-VLST 2 X IG MS NI

Extensions, 2 x female thread, parallel - nickel-plated brass

**HANSA FLEX**

## Caratteristiche

|                         |                  |
|-------------------------|------------------|
| Temperatura d'esercizio | Max. 150 °C      |
| Pressione               | Max. 60 bar      |
| Materiale               | Ottone nichelato |

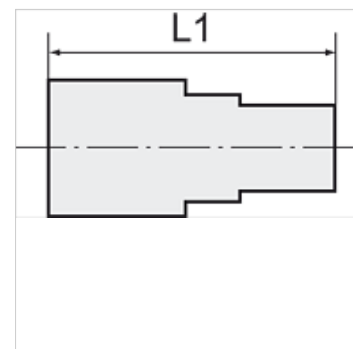
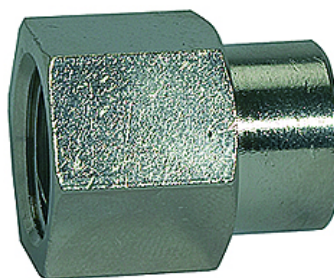

## Nota

The dimensions of the standard screw fittings may change slightly during the life of the catalogue as a result of optimisation processes.  
Altri dati su richiesta.

## Descrizione

Suitable for air, water, oil, steam, etc.

## Informazioni supplementari

Further types and dimensions on request.

## Articolo

| Denominazione  | Filettatura 1 | Filettatura 2 | L1<br>(mm) | SW    |
|----------------|---------------|---------------|------------|-------|
| K- 07 40 39 09 | M 5           | G 1/8         | 13,5       | 14 mm |
| K- 07 40 39 10 | G 1/8         | G 1/4         | 21,5       | 17 mm |
| K- 07 40 39 11 | G 1/8         | G 3/8         | 23,5       | 22 mm |
| K- 07 40 39 12 | G 1/4         | G 3/8         | 25,5       | 22 mm |
| K- 07 40 39 13 | G 1/4         | G 1/2         | 28,5       | 24 mm |
| K- 07 40 39 14 | G 3/8         | G 1/2         | 29,5       | 24 mm |
| K- 07 40 39 15 | G 1/2         | G 3/4         | 30,0       | 32 mm |
| K- 07 40 43 91 | G 1/2         | G 1/8         | 24,0       | 24 mm |
| K- 07 40 43 92 | G 1           | G 3/4         | 25,0       | 38 mm |