

K-SCHLAUCHTUELLEN MS

Hose fittings

HANSA FLEX

Caratteristiche

Pressione di lavoro	10 bar
Temperatura del fluido	max. +90 °C
Temperatura ambiente	Max. +90 °C
Materiale	Ottone

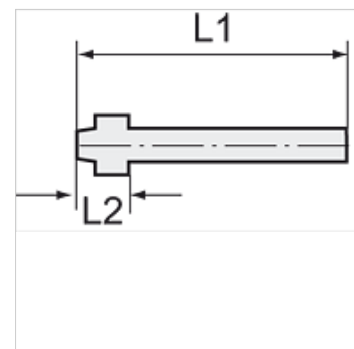

Nota

The dimensions of the standard screw fittings may change slightly during the life of the catalogue as a result of optimisation processes.
Altri dati su richiesta.

Informazioni supplementari

Further types and dimensions on request.

Articolo

Denominazione	per flessibile	per dado per raccordi	L1 (mm)	L2 (mm)
K- 07 40 16 61	LW 4 mm	G 1/8	47,0	12,0
K- 07 40 16 52	LW 4 mm	G 1/4	47,0	13,5
K- 07 40 16 54	LW 9 mm	G 1/4	47,0	13,5
K- 07 40 16 55	LW 4 mm	G 3/8	48,5	15,0
K- 07 40 16 58	LW 6 mm	G 1/2	48,5	15,0
K- 07 40 16 60	LW 13 mm	G 1/2	48,5	15,0