

K-MUFFEN VALUE LINE MS NI

Sockets

HANSA FLEX

Caratteristiche

pressione d'esercizio max.	60 bar
temperatura d'esercizio max.	150 °C
Materiale	Ottone nichelato

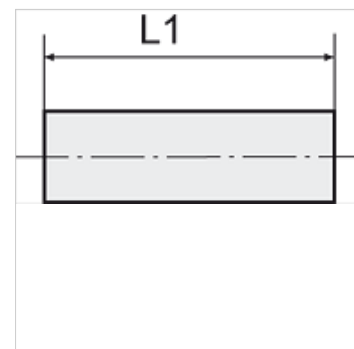

Nota

The dimensions of the standard screw fittings may change slightly during the life of the catalogue as a result of optimisation processes.
Altri dati su richiesta.

Descrizione

For air, water, steam, oil, etc.

Articolo

Denominazione	Filetto	L1 (mm)	SW
K- 07 40 15 16	M 5	11,0	8 mm
K- 07 40 15 17	G 1/8	15,0	14 mm
K- 07 40 15 18	G 1/4	22,0	17 mm
K- 07 40 15 19	G 3/8	23,0	22 mm
K- 07 40 15 20	G 1/2	28,0	26 mm
K- 07 40 15 21	G 3/4	32,0	32 mm