

K-SVB POM BLAU

Bulkhead connectors, complete with fixing nuts

HANSA FLEX

Caratteristiche

Pressione d'esercizio 0 - 10 bar

Campo della temperatura: -10 °C to +60 °C

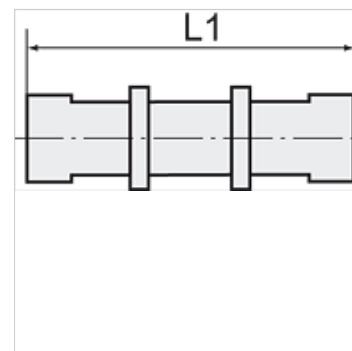
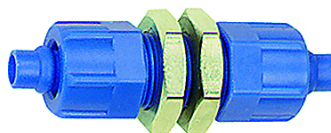

Nota

Altri dati su richiesta.

Articolo

Denominazione	Filetto	per flessibile	L1 (mm)	SW
K- 07 40 33 47	M 10 x 1	6 mm / 4 mm	50,0	13 mm
K- 07 40 33 48	M 12 x 1	8 mm / 6 mm	51,0	17 mm
K- 07 40 33 49	M 16 x 1	12 mm / 9 mm	60,0	19 mm