

K-3/2-BKR MULTIFIX MINI

Ball valves

HANSA FLEX

Caratteristiche

Temperatura del fluido	max. 60 °C
Temperatura ambiente	Max. 60 °C
Azionamento	Twist knob, rotatable 90°
Portata	1800 l/min
Attacco per sfiato	Silencer G 1/4
Materiale di tenuta	NBR
Alloggiamento	Die-cast zinc
Misurazione del valore della portata	At P1 = 6 bar and pressure drop $\Delta p = 1$ bar

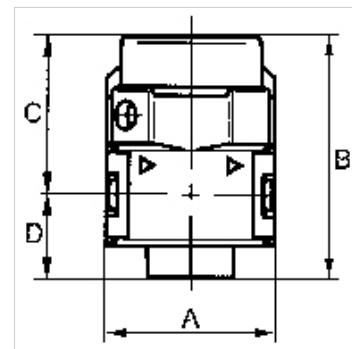
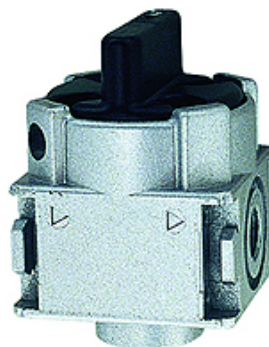

Nota

If several devices in the »multiflex-mini« Series are assembled together, the maximum working pressure is 12 bar.

Altri dati su richiesta.

Descrizione

Rotary switch can be turned 90°, lockable, with relief port

Articolo

Denominazione	Filetto	A (mm)	B	C (mm)	D (mm)	Dimensioni strutturali
K- 07 25 11 56	G 1/8	40,0	57,6 mm	37,6	20,0	0
K- 07 25 11 57	G 1/4	40,0	57,6 mm	37,6	20,0	0

Parti di ricambio

K-KOPPELPAKET MEHR	Coupling packet
K-AUTOMAT ABLASSVENTIL	Automatic drain valve
K-SCHALLDAE SINTERBR SCHLITZ	Silencers, sintered bronze, slotted