

# K-VT MULTIFIX MINI

## Manifold



### Caratteristiche

Pressione d'ingresso	Max. 16 bar
Temperatura del fluido	max. 60 °C
Temperatura ambiente	Max. 60 °C
Portata	P-A = 2700 l/min\nP-B and P-C = 1300 l/min
Materiale di tenuta	NBR
Alloggiamento	Die-cast zinc
Misurazione del valore della portata	At P1 = 6 bar and pressure drop $\Delta p = 1$ bar

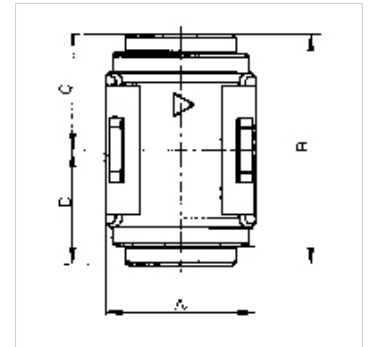
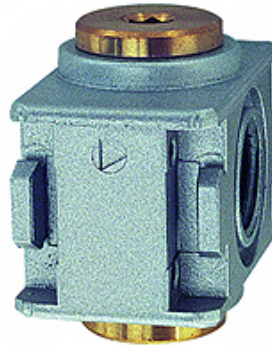

### Nota

If several devices in the »multiflex-mini« Series are assembled together, the maximum working pressure is 12 bar.  
Altri dati su richiesta.

### Descrizione

Narrow, two-way manifold with two G 1/8 outlets.

### Articolo

Denominazione	Filetto	A (mm)	B	C (mm)	D (mm)
K- 07 25 11 81	G 1/4	23,0	36,0 mm	18,0	18,0

### Parti di ricambio

K-KOPPELPAKET MEHR	Coupling packet
--------------------	-----------------