

K-VERSCHRAUBUNGEN PP

Unions - polypropylene

HANSA FLEX

Caratteristiche

Pressione d'esercizio	Dependent on operating temperature: Max. 10 bar (at 20 °C); Max. 2.5 bar (at 90 °C)
Materiale	Polypropylene (PP)
Temperatura d'esercizio	Max. 90 °C

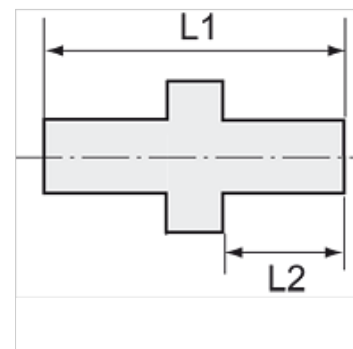
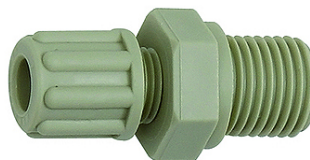

Nota

Altri dati su richiesta.

Descrizione

Chemically resistant to almost all inorganic acids and bases, even in high concentrations and at temperatures greater than 90 °C.

Articolo

Denominazione	per flessibile	Filetto	L1 (mm)	L2 (mm)	SW
K- 07 40 40 96	4 mm / 6 mm	G 1/8	31,5	8,0	14 mm
K- 07 40 40 98	6 mm / 8 mm	G 1/8	36,5	8,0	17 mm
K- 07 40 41 00	8 mm / 10 mm	G 1/8	40,5	8,0	19 mm
K- 07 40 41 02	9 mm / 12 mm	G 1/8	44,5	8,0	22 mm
K- 07 40 41 03	4 mm / 6 mm	G 1/4	37,0	12,0	17 mm
K- 07 40 41 05	6 mm / 8 mm	G 1/4	41,0	12,0	17 mm
K- 07 40 41 07	8 mm / 10 mm	G 1/4	45,0	12,0	19 mm
K- 07 40 41 09	9 mm / 12 mm	G 1/4	49,0	12,0	22 mm
K- 07 40 41 11	4 mm / 6 mm	G 3/8	38,5	12,0	22 mm
K- 07 40 41 13	6 mm / 8 mm	G 3/8	42,5	12,0	22 mm
K- 07 40 41 15	8 mm / 10 mm	G 3/8	45,5	12,0	22 mm
K- 07 40 41 17	9 mm / 12 mm	G 3/8	49,5	12,0	22 mm
K- 07 40 41 19	4 mm / 6 mm	G 1/2	43,0	14,0	27 mm
K- 07 40 41 21	6 mm / 8 mm	G 1/2	47,0	14,0	27 mm
K- 07 40 41 23	8 mm / 10 mm	G 1/2	50,0	14,0	27 mm
K- 07 40 41 25	9 mm / 12 mm	G 1/2	54,0	14,0	27 mm