

K-L-STECKVER ABSP DREH AG OR

Angle stop valves, swivel type, parallel male thread with O-ring

HANSA FLEX

Caratteristiche

| | |
|-----------------------------|--|
| Pressione di lavoro | Max. 10 bar, vacuum |
| Campo di impiego | Air, vacuum |
| Tubi flessibili consigliati | PU or PA (nylon) |
| Mezzi | Aria compressa |
| Norma | G thread acc. to DIN EN ISO 228-1, with O-Ring |
| Campo della temperatura: | 0 °C to +60 °C |
| Superficie di tenuta | O-ring (NBR) |
| Materiale | Plastic, Nickel plated brass |
| Anello di compressione | Plastic |

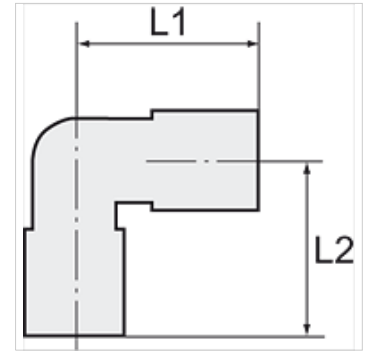

Nota

Altri dati su richiesta.

Descrizione

The air supply is completely shut off as soon as the hose is disconnected from the union.
The flow rate is only guaranteed if the hose is securely inserted.

Articolo

| Denominazione | Filetto | per diametro esterno del tubo flessibile Ø mm | L1 (mm) | L2 (mm) | SW |
|----------------|---------|---|---------|---------|-------|
| K- 07 40 08 46 | M 5 | 4 mm | 31,0 | 21,3 | 10 mm |
| K- 07 40 08 47 | M 5 | 6 mm | 29,4 | 21,7 | 12 mm |
| K- 07 40 08 40 | G 1/8 | 4 mm | 31,0 | 24,3 | 14 mm |
| K- 07 40 08 41 | G 1/8 | 6 mm | 29,4 | 24,2 | 14 mm |
| K- 07 40 08 42 | G 1/8 | 8 mm | 33,0 | 27,0 | 14 mm |
| K- 07 40 08 38 | G 1/4 | 6 mm | 29,4 | 26,7 | 17 mm |
| K- 07 40 08 39 | G 1/4 | 8 mm | 33,0 | 29,5 | 17 mm |
| K- 07 40 08 37 | G 1/4 | 10 mm | 42,5 | 34,3 | 17 mm |
| K- 07 40 08 45 | G 3/8 | 8 mm | 33,0 | 30,0 | 20 mm |
| K- 07 40 08 43 | G 3/8 | 10 mm | 42,5 | 34,3 | 20 mm |
| K- 07 40 08 44 | G 3/8 | 12 mm | 46,5 | 36,0 | 21 mm |
| K- 07 40 08 35 | G 1/2 | 10 mm | 42,5 | 37,8 | 24 mm |
| K- 07 40 08 36 | G 1/2 | 12 mm | 46,5 | 39,0 | 24 mm |