

# K-SCHL-AUFROLLER SCHWEISS

Hose reel, welding type

**HANSA FLEX**

## Caratteristiche

<b>Tubi flessibili</b>	Welding hose for oxygen and acetylene, red and blue, made from synthetic rubber.
<b>Pressione d'esercizio</b>	max. 10 bar
<b>Elemento di fissaggio</b>	Wall, floor or ceiling
<b>Ingresso</b>	Oxygen G 1/4 male, right-hand thread with 60° inside cone, Acetylene G 3/8 male, left-hand thread with 60° inside cone

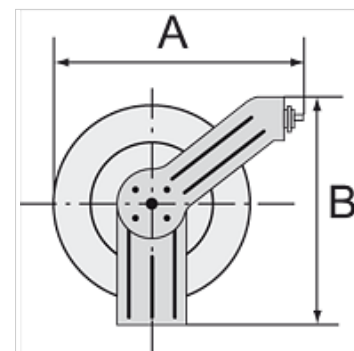

## Nota

Altri dati su richiesta.

## Descrizione

Heavy-duty steel design for industrial applications. Blue, powder-coated housing. Special reel guide prevents excessive wear on the hose. An automatic latching mechanism allows the hose to be engaged at any length. Enclosed spring. Precise locking device for continuous feeding or latching mechanism.

## Articolo

Denominazione	Dimensione tubo flessibile	Altezza (mm)	Diametro (mm)	Lunghezza tubo flessibile (m)
K- 07 10 06 28	Oxygen: 16.5 mm x 6 mm, Acetylene: 17 mm x 10 mm	360	320	15