

K-RD DURCHGANGSFORM LEI VA

Check valve - straight-way type, lightweight series, stainless steel

HANSA FLEX

Caratteristiche

Pressione d'esercizio	2 - 16 bar
Temperatura d'esercizio	-20 °C to +150 °C
Pressione di apertura	min. 0.03 bar
Materiale di tenuta	FKM
Molla	Stainless steel 1.4301
Alloggiamento	Stainless steel 1.4301

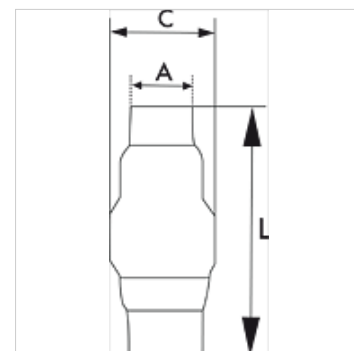

Nota

Altri dati su richiesta.

Descrizione

Stainless steel check valve with full bore and very low opening pressure, no maintenance required. Applications: Compressed air, water, neutral gases, gaseous and liquid non-corrosive media, oils.

Articolo

Denominazione	Filetto	A (mm)	C (mm)	L (mm)
K- 07 30 29 23	G 1/4	20,0	32,0	55,9
K- 07 30 29 28	G 3/8	20,0	32,0	56,0
K- 07 30 29 22	G 1/2	25,0	32,0	55,6
K- 07 30 29 27	G 3/4	29,0	44,0	66,7
K- 07 30 29 19	G 1	36,0	53,0	83,6
K- 07 30 29 21	G 1 1/4	45,0	62,0	96,0
K- 07 30 29 20	G 1 1/2	51,0	78,0	114,0
K- 07 30 29 24	G 2	64,0	89,0	120,5
K- 07 30 29 25	G 2 1/2	80,0	113,0	141,5
K- 07 30 29 26	G 3	94,0	132,0	160,0