

# K-L-STECKVER DREH AG-K VA

Male elbows, swivel type, conical male thread

**HANSA FLEX**

## Caratteristiche

Pressione di lavoro a impulsi	Max. 10 bar
Pressione	Max. 15 bar (depending on pipe quality)
materiale del tubo idoneo	PVDF, PTFE, stainless steel, PA, PU
Norma	R thread acc. to ISO 7-1
Temperatura ambiente	-20 °C to max. +150 °C (depending on pipe quality and diameter)
Materiale	Acciaio inossidabile 1.4404
Materiale di tenuta	FKM

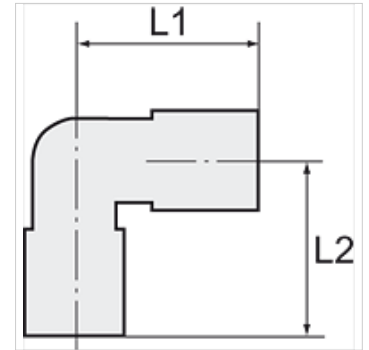

## Nota

Altri dati su richiesta.

## Descrizione

For use with aggressive media and in areas with corrosive outside influences, in the food processing industry and in hygienic and sanitary applications.

## Articolo

Denominazione	Filetto	per diametro esterno del tubo flessibile Ø mm	L1 (mm)	L2 (mm)	SW
K- 07 40 24 44	R 1/8	4 mm	17,0	17,5	10 mm
K- 07 40 24 45	R 1/8	6 mm	21,5	20,0	13 mm
K- 07 40 24 46	R 1/8	8 mm	22,0	20,0	13 mm
K- 07 40 24 42	R 1/4	6 mm	21,5	24,0	14 mm
K- 07 40 24 43	R 1/4	8 mm	22,0	24,0	14 mm
K- 07 40 24 41	R 1/4	10 mm	25,5	26,5	16 mm
K- 07 40 24 47	R 3/8	10 mm	25,5	27,0	17 mm
K- 07 40 24 48	R 3/8	12 mm	28,0	30,5	22 mm
K- 07 40 24 40	R 1/2	12 mm	28,0	33,5	22 mm