

K-STECKVERSCHR IG SK 1

Male connectors, parallel female thread with outer hex

HANSA FLEX

Caratteristiche

Pressione di lavoro	Max. 16 bar
Temperatura d'esercizio	-20 °C to +150 °C
Materiale	Ottone nichelato
Anello di compressione	Nickel-plated brass
Anello elastico	Stainless steel

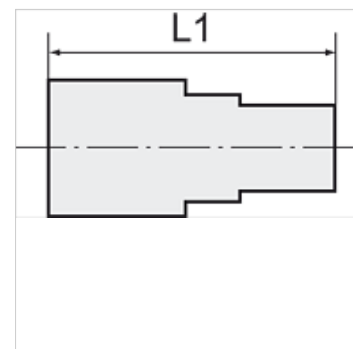
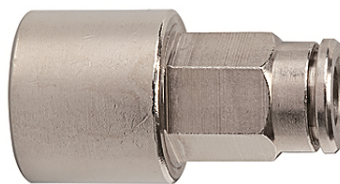

Nota

Altri dati su richiesta.

Descrizione

Push-in fittings, manufactured entirely in nickel-plated brass. All parts with a parallel thread are supplied with an FPM O-ring. All parts with conical threads are coated with preCOTE 5 dispersion, all fittings in this series can thus also be used at high temperatures (medium compressed air).

Articolo

Denominazione	Filetto	per diametro esterno del tubo flessibile Ø mm	L1 (mm)	SW
K- 07 40 27 46	G 1/8	4 mm	26,5	9 mm
K- 07 40 27 47	G 1/8	6 mm	27,0	11 mm
K- 07 40 27 48	G 1/8	8 mm	28,0	13 mm
K- 07 40 47 71	G 1/4	4 mm	29,5	9 mm
K- 07 40 27 44	G 1/4	6 mm	31,0	11 mm
K- 07 40 27 45	G 1/4	8 mm	32,0	13 mm
K- 07 40 27 43	G 1/4	10 mm	32,0	16 mm
K- 07 40 47 70	G 1/4	12 mm	40,0	20 mm
K- 07 40 47 72	G 3/8	10 mm	37,5	20 mm
K- 07 40 47 73	G 3/8	12 mm	39,5	20 mm