

# K-T-MEHRF-VERT 6 DREH

Tee distributors with inner hex, 6 outlets, swivel type, conical male thread, coated

**HANSA FLEX**

## Caratteristiche

<b>Pressione di lavoro</b>	Max. 15 bar, coarse vacuum
<b>Campo di impiego</b>	Air, vacuum
<b>Tubi flessibili consigliati</b>	PU or PA (nylon)
<b>Mezzi</b>	Compressed air and all gases or liquids that are compatible with the materials
<b>Campo della temperatura:</b>	-20 °C to +80 °C
<b>Superficie di tenuta</b>	Conical version: thread coating
<b>Materiale</b>	Plastic, Nickel plated brass
<b>Anello di compressione</b>	Plastic

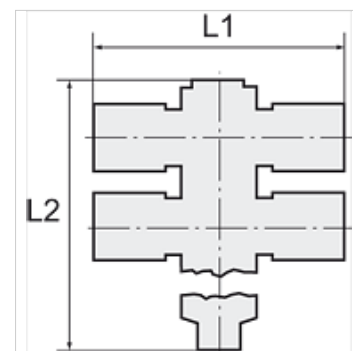

## Nota

Altri dati su richiesta.

## Descrizione

Push-in fittings series manufactured in plastic and nickel-plated brass. All parts are suitable for use with hoses, tubes or pipes made of plastic and copper.

## Articolo

Denominazione	Filetto	per diametro esterno del tubo flessibile Ø mm	Esagono cavo (mm)	L1 (mm)	L2 (mm)	SW
K- 07 40 06 49	R 1/8	4 mm	4,0	45,0	59,6	14 mm
K- 07 40 06 50	R 1/8	6 mm	4,0	43,0	59,6	14 mm
K- 07 40 06 51	R 1/8	8 mm	4,0	49,0	59,6	14 mm
K- 07 40 06 46	R 1/4	6 mm	6,0	47,0	81,0	17 mm
K- 07 40 06 47	R 1/4	8 mm	6,0	52,0	81,0	17 mm
K- 07 40 06 43	R 1/4	10 mm	6,0	59,8	81,0	17 mm
K- 07 40 06 44	R 1/4	12 mm	6,0	61,6	81,0	17 mm
K- 07 40 06 55	R 3/8	8 mm	8,0	57,0	83,7	20 mm
K- 07 40 06 52	R 3/8	10 mm	8,0	63,8	83,7	20 mm
K- 07 40 06 53	R 3/8	12 mm	8,0	65,6	83,7	20 mm