

Caratteristiche

| | |
|------------------------------------|--|
| Pressione di lavoro | Max. 15 bar, coarse vacuum |
| Campo di impiego | Air, vacuum |
| Tubi flessibili consigliati | PU or PA (nylon) |
| Mezzi | Compressed air and all gases or liquids that are compatible with the materials |
| Campo della temperatura: | -20 °C to +80 °C |
| Superficie di tenuta | Parallel version: O-ring in housing, Conical version: thread coating |
| Materiale | Plastic, Nickel plated brass |
| Anello di compressione | Plastic |

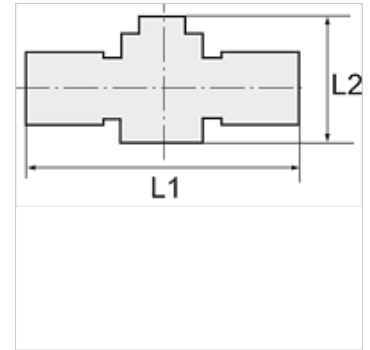

Nota

Altri dati su richiesta.

Descrizione

Push-in fittings series manufactured in plastic and nickel-plated brass. All parts are suitable for use with hoses, tubes or pipes made of plastic and copper.

Articolo

| Denominazione | Filettatura 1 | Filettatura 2 | L1 (mm) | L2 (mm) | SW |
|----------------|---------------|---------------|---------|---------|---------------|
| K- 07 40 07 81 | R 1/8 | R 1/8 | 65,0 | 42,6 | 12 mm |
| K- 07 40 07 80 | R 1/4 | R 1/8 | 67,5 | 42,6 | 14 mm / 12 mm |
| K- 07 40 07 79 | R 1/4 | R 1/4 | 70,0 | 42,6 | 14 mm |
| K- 07 40 07 82 | R 3/8 | R 1/4 | 82,0 | 47,0 | 17 mm / 14 mm |
| K- 07 40 07 83 | R 3/8 | R 3/8 | 83,5 | 47,0 | 17 mm |
| K- 07 40 07 78 | R 1/2 | R 3/8 | 87,0 | 47,0 | 21 mm / 17 mm |
| K- 07 40 07 77 | R 1/2 | R 1/2 | 90,5 | 47,0 | 21 mm |