

# K-ABSPV STECK GEW SCH BESCH

Shut-off valves, male thread, plug connection, flow direction to tube, conical thread, coated

**HANSA FLEX**

## Caratteristiche

<b>Pressione di lavoro</b>	Max. 15 bar, coarse vacuum
<b>Campo di impiego</b>	Air, vacuum
<b>Tubi flessibili consigliati</b>	PU or PA (nylon)
<b>Mezzi</b>	Compressed air and all gases or liquids that are compatible with the materials
<b>Campo della temperatura:</b>	-20 °C to +80 °C
<b>Superficie di tenuta</b>	Parallel version: O-ring in housing, Conical version: thread coating
<b>Materiale</b>	Plastic, Nickel plated brass
<b>Anello di compressione</b>	Plastic

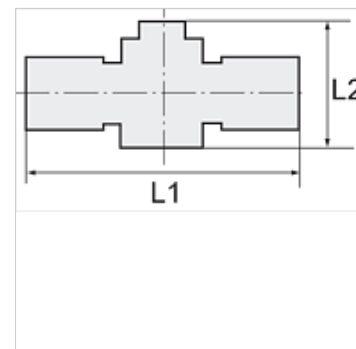

## Nota

Altri dati su richiesta.

## Descrizione

Push-in fittings series manufactured in plastic and nickel-plated brass. All parts are suitable for use with hoses, tubes or pipes made of plastic and copper.

## Articolo

Denominazione	Filetto	per diametro esterno del tubo flessibile Ø mm	L1 (mm)	L2 (mm)	SW
K- 07 40 07 90	R 1/8	6 mm	58,0	42,6	12 mm
K- 07 40 07 91	R 1/8	8 mm	58,9	42,6	14 mm
K- 07 40 07 88	R 1/4	6 mm	60,5	42,6	12 mm
K- 07 40 07 89	R 1/4	8 mm	60,9	42,6	14 mm
K- 07 40 07 86	R 1/4	10 mm	72,4	47,0	17 mm
K- 07 40 07 87	R 1/4	12 mm	73,3	47,0	21 mm
K- 07 40 07 94	R 3/8	8 mm	62,4	42,6	17 mm
K- 07 40 07 92	R 3/8	10 mm	73,4	47,0	17 mm
K- 07 40 07 93	R 3/8	12 mm	74,3	47,0	21 mm
K- 07 40 07 84	R 1/2	10 mm	76,9	47,0	21 mm
K- 07 40 07 85	R 1/2	12 mm	77,3	47,0	21 mm