

K-GAM IG VALUE LINE

Female connectors, female thread

HANSA FLEX

Caratteristiche

Pressione d'esercizio	Max. 16 bar (at +20 °C)
Temperatura d'esercizio	-20 °C to +70 °C
Materiale	Ottone nichelato
Anello di compressione	Hostaform (black nickel-plated for Ø 10, 12)
O-ring	NBR, siliconefree
Pinza a trazione	Stainless steel AISI 316

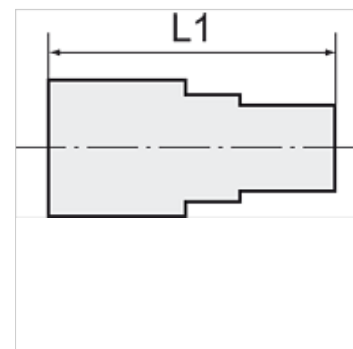

Nota

Altri dati su richiesta.

Descrizione

Economy yet very high-quality series of push-in fittings made of nickel-plated brass. Compact, space-saving, lightweight design. An O-ring in the fillet at the end of the thread guarantees a tight connection for all male thread parts, even on rough surfaces.

Articolo

Denominazione	Filetto	per diametro esterno del tubo flessibile Ø mm	L1 (mm)	SW
K- 07 40 29 39	G 1/8	4 mm	26,5	9 mm
K- 07 40 29 38	G 1/4	8 mm	32,0	13 mm
K- 07 40 29 36	G 1/4	10 mm	32,0	16 mm
K- 07 40 29 40	G 1/8	6 mm	27,0	11 mm
K- 07 40 29 41	G 1/8	8 mm	28,0	13 mm
K- 07 40 29 37	G 1/4	6 mm	31,0	11 mm