

K-TUE IG ES

Female hose fittings with female thread stainless steel

HANSA FLEX

Caratteristiche

Pressione di lavoro Max. 20 bar

Materiale Acciaio inossidabile 1.4571

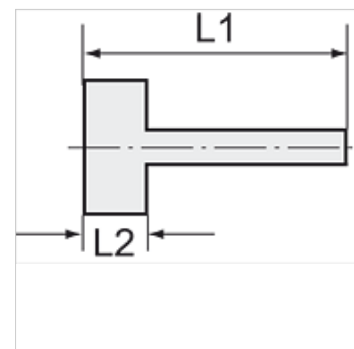
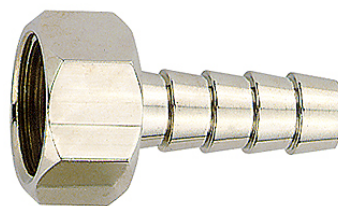

Nota

The dimensions of the standard screw fittings may change slightly during the life of the catalogue as a result of optimisation processes.
Altri dati su richiesta.

Informazioni supplementari

Further types and dimensions on request.

Articolo

Denominazione	Filetto	per flessibile	L1 (mm)	L2 (mm)	SW
K- 07 40 13 30	G 1/8	LW 6 mm	35,0	10,0	12 mm
K- 07 40 13 31	G 1/8	LW 8 mm	35,0	10,0	12 mm
K- 07 40 13 32	G 1/4	LW 6 mm	36,0	11,0	17 mm
K- 07 40 13 33	G 1/4	LW 8 mm	36,0	11,0	17 mm
K- 07 40 13 34	G 1/4	LW 10 mm	36,0	11,0	17 mm
K- 07 40 13 35	G 1/4	LW 13 mm	40,5	11,0	17 mm
K- 07 40 13 36	G 3/8	LW 6 mm	36,0	11,0	19 mm
K- 07 40 13 37	G 3/8	LW 8 mm	36,0	11,0	19 mm
K- 07 40 13 38	G 3/8	LW 10 mm	36,0	11,0	19 mm
K- 07 40 13 39	G 3/8	LW 13 mm	40,5	11,0	19 mm
K- 07 40 13 40	G 1/2	LW 6 mm	39,0	14,5	24 mm
K- 07 40 13 41	G 1/2	LW 8 mm	39,0	14,5	24 mm
K- 07 40 13 42	G 1/2	LW 10 mm	39,0	14,5	24 mm
K- 07 40 13 43	G 1/2	LW 13 mm	44,0	14,5	24 mm