

Savybės

| | |
|----------------------------|---|
| 1 jungtis | metrinis cilindrinis išorinis sriegis |
| 1 sandarinimo forma | B forma |
| 2 jungtis | metrinis cilindrinis išorinis sriegis |
| 2 sandarinimo forma | 24° vidinis kūgis |
| Konstrukcija | Įsukama srieginė jungtis |
| Gaminio forma | tiesus |
| Norma | DIN 2353 ISO 8434-1 |
| Tiekimo apimtis | Vamzdžio antgalis (be užmetamos veržlės ir pjovimo žiedo) |
| Medžiaga | Plienas |
| Paviršiaus apsauga | padengtas galvaniniu būdu |

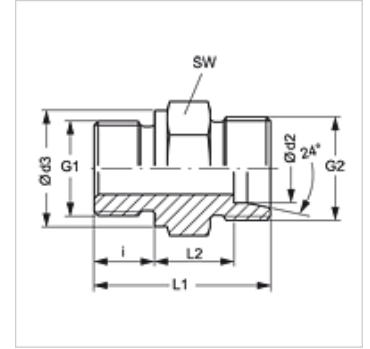

Nuoroda

Nuorodų dėl montavimo, įstatymo, slėginės apkrovos ir leidžiamų darbinių temperatūrų žr. srieginių vamzdžių jungčių techninės informacijos dokumentacijoje.

Prekė

| Pavadinimas | Serija | Darbinis slėgis bar | Ø d2 (mm) | G1 | G2 | Ø d3 (mm) | i (mm) | L1 (mm) | L2 (mm) | SW (mm) |
|---------------------|--------|---------------------|-----------|------------|------------|-----------|--------|---------|---------|---------|
| XVM 16 LL | LL | PN 100 | 16 | M 22 x 1,5 | M 22 x 1,5 | 27 | 14 | 36,5 | 15,5 | 27 |
| XVM 16 LL 18-1.5 | LL | PN 100 | 16 | M 18 x 1,5 | M 22 x 1,5 | 23 | 12 | 33,5 | 14,5 | 24 |
| XVM NW 04 HL | L | PN 315 | 6 | M 10 x 1 | M 12 x 1,5 | 14 | 8 | 23,5 | 8,5 | 14 |
| XVM NW 04 HL 12 | L | PN 315 | 6 | M 12 x 1,5 | M 12 x 1,5 | 17 | 12 | 28,0 | 9,0 | 17 |
| XVM NW 04 HL 14 | L | PN 315 | 6 | M 14 x 1,5 | M 12 x 1,5 | 19 | 12 | 28,0 | 9,0 | 19 |
| XVM NW 04 HL 16 | L | PN 315 | 6 | M 16 x 1,5 | M 12 x 1,5 | 21 | 12 | 28,0 | 9,0 | 22 |
| XVM NW 04 HL 18 | L | PN 315 | 6 | M 18 x 1,5 | M 12 x 1,5 | 23 | 12 | 28,5 | 9,5 | 24 |
| XVM NW 04 HL 22 | L | PN 315 | 6 | M 22 x 1,5 | M 12 x 1,5 | 27 | 14 | 31,0 | 10,0 | 27 |
| XVM NW 06 HL | L | PN 315 | 8 | M 12 x 1,5 | M 14 x 1,5 | 17 | 12 | 29,0 | 10,0 | 17 |
| XVM NW 06 HL 10 | L | PN 315 | 8 | M 10 x 1 | M 14 x 1,5 | 14 | 8 | 24,5 | 9,5 | 17 |
| XVM NW 06 HL 14 | L | PN 315 | 8 | M 14 x 1,5 | M 14 x 1,5 | 19 | 12 | 29,0 | 10,0 | 19 |
| XVM NW 06 HL 16 | L | PN 315 | 8 | M 16 x 1,5 | M 14 x 1,5 | 21 | 12 | 29,0 | 10,0 | 22 |
| XVM NW 06 HL 18 | L | PN 315 | 8 | M 18 x 1,5 | M 14 x 1,5 | 23 | 12 | 29,5 | 10,5 | 24 |
| XVM NW 06 HL 22 | L | PN 315 | 8 | M 22 x 1,5 | M 14 x 1,5 | 27 | 14 | 32,0 | 11,0 | 27 |
| XVM NW 08 HL | L | PN 315 | 10 | M 14 x 1,5 | M 16 x 1,5 | 19 | 12 | 30,0 | 11,0 | 19 |
| XVM NW 08 HL 12 | L | PN 315 | 10 | M 12 x 1,5 | M 16 x 1,5 | 17 | 12 | 30,0 | 11,0 | 17 |
| XVM NW 08 HL 16 | L | PN 315 | 10 | M 16 x 1,5 | M 16 x 1,5 | 21 | 12 | 30,0 | 11,0 | 22 |
| XVM NW 08 HL 18 | L | PN 315 | 10 | M 18 x 1,5 | M 16 x 1,5 | 23 | 12 | 30,5 | 11,5 | 24 |
| XVM NW 08 HL 22 | L | PN 315 | 10 | M 22 x 1,5 | M 16 x 1,5 | 27 | 14 | 33,0 | 12,0 | 27 |
| XVM NW 10 HL | L | PN 315 | 12 | M 16 x 1,5 | M 18 x 1,5 | 21 | 12 | 31,5 | 12,5 | 22 |
| XVM NW 10 HL 12 | L | PN 315 | 12 | M 12 x 1,5 | M 18 x 1,5 | 17 | 12 | 31,5 | 12,5 | 19 |
| XVM NW 10 HL 14 | L | PN 315 | 12 | M 14 x 1,5 | M 18 x 1,5 | 19 | 12 | 31,5 | 12,5 | 22 |
| XVM NW 10 HL 18 | L | PN 315 | 12 | M 18 x 1,5 | M 18 x 1,5 | 23 | 12 | 32,0 | 13,0 | 24 |
| XVM NW 10 HL 22 | L | PN 315 | 12 | M 22 x 1,5 | M 18 x 1,5 | 27 | 14 | 34,5 | 13,5 | 27 |
| XVM NW 10 HL 24 | L | PN 315 | 12 | M 24 x 1,5 | M 18 x 1,5 | 29 | 14 | 34,5 | 13,5 | 32 |
| XVM NW 10 HL 26 | L | PN 315 | 12 | M 26 x 1,5 | M 18 x 1,5 | 31 | 16 | 36,5 | 13,5 | 32 |
| XVM NW 13 HL | L | PN 315 | 15 | M 18 x 1,5 | M 22 x 1,5 | 23 | 12 | 32,5 | 13,5 | 24 |
| XVM NW 13 HL 14 | L | PN 315 | 15 | M 14 x 1,5 | M 22 x 1,5 | 19 | 12 | 32,0 | 13,0 | 24 |
| XVM NW 13 HL 16 | L | PN 315 | 15 | M 16 x 1,5 | M 22 x 1,5 | 21 | 12 | 32,0 | 13,0 | 24 |
| XVM NW 13 HL 20 | L | PN 250 | 15 | M 20 x 1,5 | M 22 x 1,5 | 25 | 14 | 34,5 | 13,5 | 27 |
| XVM NW 13 HL 22 | L | PN 315 | 15 | M 22 x 1,5 | M 22 x 1,5 | 27 | 14 | 35,0 | 14,0 | 27 |
| XVM NW 13 HL 26 | L | PN 315 | 15 | M 26 x 1,5 | M 22 x 1,5 | 31 | 16 | 37,0 | 14,0 | 32 |
| XVM NW 13 HL 30 | L | PN 315 | 15 | M 30 x 2 | M 22 x 1,5 | 36 | 16 | 37,0 | 14,0 | 41 |
| XVM NW 16 HL | L | PN 315 | 18 | M 22 x 1,5 | M 26 x 1,5 | 27 | 14 | 36,0 | 14,5 | 27 |
| XVM NW 16 HL 18 | L | PN 315 | 18 | M 18 x 1,5 | M 26 x 1,5 | 23 | 12 | 33,5 | 14,0 | 27 |
| XVM NW 16 HL 26 | L | PN 315 | 18 | M 26 x 1,5 | M 26 x 1,5 | 31 | 16 | 38,0 | 14,5 | 32 |
| XVM NW 16 HL 27 | L | PN 315 | 18 | M 27 x 2 | M 26 x 1,5 | 32 | 16 | 38,0 | 14,5 | 32 |
| XVM NW 16 HL 30-1.5 | L | PN 315 | 18 | M 30 x 1,5 | M 26 x 1,5 | 36 | 16 | 38,0 | 14,5 | 41 |
| XVM NW 20 HL | L | PN 160 | 22 | M 26 x 1,5 | M 30 x 2 | 31 | 16 | 40,0 | 16,5 | 32 |
| XVM NW 20 HL 18 | L | PN 160 | 22 | M 18 x 1,5 | M 30 x 2 | 23 | 12 | 35,5 | 16,0 | 32 |
| XVM NW 20 HL 22 | L | PN 160 | 22 | M 22 x 1,5 | M 30 x 2 | 27 | 14 | 38,0 | 16,5 | 32 |



Prekė

| Pavadinimas | Serija | Darbinis slėgis bar | Ø d2 (mm) | G1 | G2 | Ø d3 (mm) | i (mm) | L1 (mm) | L2 (mm) | SW (mm) |
|-----------------------|--------|---------------------|-----------|------------|------------|-----------|--------|---------|---------|---------|
| XVM NW 20 HL 22-LS 20 | L | PN 160 | 22 | M 22 x 1,5 | M 30 x 2 | 27 | 14 | 60,0 | 38,5 | 32 |
| XVM NW 20 HL 30-1.5 | L | PN 160 | 22 | M 30 x 1,5 | M 30 x 2 | 36 | 16 | 40,0 | 16,5 | 41 |
| XVM NW 20 HL 33-LS 20 | L | PN 160 | 22 | M 33 x 2 | M 30 x 2 | 39 | 18 | 62,0 | 36,5 | 41 |
| XVM NW 25 HL | L | PN 160 | 28 | M 33 x 2 | M 36 x 2 | 39 | 18 | 43,0 | 17,5 | 41 |
| XVM NW 25 HL-LS 20 | L | PN 160 | 28 | M 33 x 2 | M 36 x 2 | 39 | 18 | 60,0 | 23,5 | 41 |
| XVM NW 25 HL 22 | L | PN 160 | 28 | M 22 x 1,5 | M 36 x 2 | 27 | 14 | 39,0 | 17,5 | 41 |
| XVM NW 25 HL 26 | L | PN 160 | 28 | M 26 x 1,5 | M 36 x 2 | 31 | 16 | 41,0 | 17,5 | 41 |
| XVM NW 25 HL 27 | L | PN 160 | 28 | M 27 x 2 | M 36 x 2 | 32 | 16 | 41,0 | 17,5 | 41 |
| XVM NW 25 HL 42 | L | PN 160 | 28 | M 42 x 2 | M 36 x 2 | 49 | 22 | 45,0 | 17,5 | 50 |
| XVM NW 32 HL | L | PN 160 | 35 | M 42 x 2 | M 45 x 2 | 49 | 20 | 48,0 | 17,5 | 50 |
| XVM NW 40 HL | L | PN 160 | 42 | M 48 x 2 | M 52 x 2 | 55 | 22 | 52,0 | 19,0 | 55 |
| XVM NW 03 HS | S | PN 400 | 6 | M 12 x 1,5 | M 14 x 1,5 | 17 | 12 | 32,0 | 13,0 | 17 |
| XVM NW 03 HS 16 | S | PN 400 | 6 | M 16 x 1,5 | M 14 x 1,5 | 21 | 12 | 32,0 | 13,0 | 22 |
| XVM NW 03 HS 18 | S | PN 400 | 6 | M 18 x 1,5 | M 14 x 1,5 | 23 | 12 | 32,5 | 13,5 | 24 |
| XVM NW 03 HS 22 | S | PN 400 | 6 | M 22 x 1,5 | M 14 x 1,5 | 27 | 14 | 35,0 | 14,0 | 27 |
| XVM NW 04 HS | S | PN 400 | 8 | M 14 x 1,5 | M 16 x 1,5 | 19 | 12 | 34,0 | 15,0 | 19 |
| XVM NW 06 HS | S | PN 400 | 10 | M 16 x 1,5 | M 18 x 1,5 | 21 | 12 | 34,5 | 15,0 | 22 |
| XVM NW 06 HS 18 | S | PN 400 | 10 | M 18 x 1,5 | M 18 x 1,5 | 23 | 12 | 35,0 | 15,5 | 24 |
| XVM NW 06 HS 22 | S | PN 400 | 10 | M 22 x 1,5 | M 18 x 1,5 | 27 | 14 | 37,5 | 16,0 | 27 |
| XVM NW 08 HS | S | PN 400 | 12 | M 18 x 1,5 | M 20 x 1,5 | 23 | 12 | 36,5 | 17,0 | 24 |
| XVM NW 08 HS 14 | S | PN 400 | 12 | M 14 x 1,5 | M 20 x 1,5 | 19 | 12 | 36,0 | 16,5 | 22 |
| XVM NW 08 HS 16 | S | PN 400 | 12 | M 16 x 1,5 | M 20 x 1,5 | 21 | 12 | 36,0 | 16,5 | 22 |
| XVM NW 08 HS 22 | S | PN 400 | 12 | M 22 x 1,5 | M 20 x 1,5 | 27 | 14 | 39,0 | 17,5 | 27 |
| XVM NW 10 HS | S | PN 400 | 14 | M 20 x 1,5 | M 22 x 1,5 | 25 | 14 | 41,0 | 19,0 | 27 |
| XVM NW 10 HS 16 | S | PN 400 | 14 | M 16 x 1,5 | M 22 x 1,5 | 21 | 12 | 38,5 | 18,5 | 24 |
| XVM NW 10 HS 18 | S | PN 400 | 14 | M 18 x 1,5 | M 22 x 1,5 | 23 | 12 | 39,0 | 19,0 | 24 |
| XVM NW 10 HS 22 | S | PN 400 | 14 | M 22 x 1,5 | M 22 x 1,5 | 27 | 14 | 41,5 | 19,5 | 27 |
| XVM NW 13 HS | S | PN 400 | 16 | M 22 x 1,5 | M 24 x 1,5 | 27 | 14 | 41,0 | 18,5 | 27 |
| XVM NW 13 HS 16 | S | PN 400 | 16 | M 16 x 1,5 | M 24 x 1,5 | 21 | 12 | 38,0 | 17,5 | 27 |
| XVM NW 13 HS 18 | S | PN 400 | 16 | M 18 x 1,5 | M 24 x 1,5 | 23 | 12 | 38,5 | 18,0 | 27 |
| XVM NW 13 HS 26 | S | PN 400 | 16 | M 26 x 1,5 | M 24 x 1,5 | 31 | 16 | 43,0 | 18,5 | 32 |
| XVM NW 16 HS | S | PN 400 | 20 | M 27 x 2 | M 30 x 2 | 32 | 16 | 47,0 | 20,5 | 32 |
| XVM NW 16 HS 22 | S | PN 400 | 20 | M 22 x 1,5 | M 30 x 2 | 27 | 14 | 45,0 | 20,5 | 32 |
| XVM NW 16 HS 26 | S | PN 400 | 20 | M 26 x 1,5 | M 30 x 2 | 32 | 16 | 47,0 | 20,5 | 32 |
| XVM NW 16 HS 30-1.5 | S | PN 400 | 20 | M 30 x 1,5 | M 30 x 2 | 36 | 16 | 47,0 | 20,5 | 36 |
| XVM NW 20 HS | S | PN 250 | 25 | M 33 x 2 | M 36 x 2 | 39 | 18 | 53,0 | 23,0 | 41 |
| XVM NW 20 HS 26 | S | PN 250 | 25 | M 26 x 1,5 | M 36 x 2 | 32 | 16 | 49,0 | 20,0 | 41 |
| XVM NW 20 HS 27 | S | PN 250 | 25 | M 27 x 2 | M 36 x 2 | 32 | 16 | 51,0 | 23,0 | 41 |
| XVM NW 20 HS 30-1.5 | S | PN 250 | 25 | M 30 x 1,5 | M 36 x 2 | 36 | 16 | 51,0 | 23,0 | 41 |
| XVM NW 25 HS | S | PN 160 | 30 | M 42 x 2 | M 42 x 2 | 49 | 20 | 57,0 | 23,5 | 50 |
| XVM NW 25 HS 30-1.5 | S | PN 160 | 30 | M 30 x 1,5 | M 42 x 2 | 36 | 16 | 53,0 | 23,5 | 50 |
| XVM NW 25 HS 38-1.5 | S | PN 160 | 30 | M 38 x 1,5 | M 42 x 2 | 44 | 16 | 49,0 | 19,5 | 46 |
| XVM NW 32 HS | S | PN 160 | 38 | M 48 x 2 | M 52 x 2 | 55 | 22 | 64,0 | 26,0 | 55 |
| XVM NW 32 HS 38-1.5 | S | PN 160 | 38 | M 38 x 1,5 | M 52 x 2 | 49 | 20 | 58,0 | 26,0 | 50 |
| XVM NW 32 HS 45-1.5 | S | PN 160 | 38 | M 45 x 1,5 | M 52 x 2 | 55 | 22 | 58,0 | 26,0 | 55 |

Serija: LL = labai lengvas L = lengvas S = sunkus - PN = nominalusis slėgis PB = maks. darbinis slėgis - Ø d2 = išorinis vamzdžio skersmuo

Gaminių variantai

| | |
|--------|--|
| XVM VA | [sukama srieginė jungtis, nerūdijantysis plienas |
| VM | [sukama srieginė jungtis, Plienas |