

# WFG JIC U (3000 / 6000 PSI)

SAE flanšinis adapteris, nukaltas

**HANSA FLEX**

## Savybės

|                              |   |
|------------------------------|---|
| <b>Norma</b>                 | SAE J 518 C<br>ISO 6162                                   |
| <b>Konstrukcijos priedas</b> | nukaltas  |
| <b>Gaminio forma</b>         | 90° kampas  |
| <b>Konstrukcija</b>          | SAE flanšo adapteris                                      |
| <b>Tiekimo apimtis</b>       | su 2 flanšų pusėmis, varžtų rinkiniu ir sandarinimo žiedu |
| <b>Medžiaga</b>              | S355J2G3 (ST52.3)   |
| <b>Paviršiaus apsauga</b>    | padengtas galvaniniu būdu                                 |

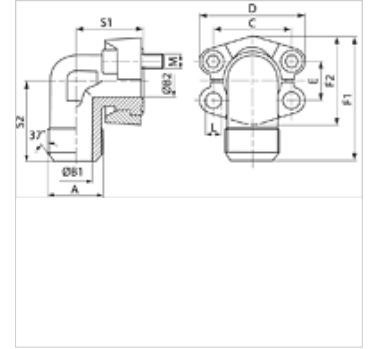

## Nuoroda

Nurodytas maksimalus darbinis slėgis nurodomas priklausomai nuo flanšo! Tikrajį darbinį slėgį reikia nustatyti pagal vamzdį (sienelės stori) ir jo kokybę!

## Prekė

| Pavadinimas           | Slėgio serija | PB 10.9 (bar) | Gaminio dydis | A              | B1   | B2   | C    | D    | E    | F1    | F2   | S1   | S2   | L    | Varžtai                |
|-----------------------|---------------|---------------|---------------|----------------|------|------|------|------|------|-------|------|------|------|------|------------------------|
|                       |               |               |               |                | (mm) | (mm) | (mm) | (mm) | (mm) | (mm)  | (mm) | (mm) | (mm) | (mm) |                        |
| WFG 3001 JIC 3/4 U    | 3000 PSI      | 350           | 1/2"          | UNF 3/4" -16   | 9,9  | 13   | 38,1 | 54   | 17,5 | 60,8  | 45,6 | 38   | 38   | 8,7  | (4 x) UNC 5/16 x 1.1/4 |
| WFG 3001 JIC 7/8 U    | 3000 PSI      | 350           | 1/2"          | UNF 7/8" -14   | 12,3 | 13   | 38,1 | 54   | 17,5 | 60,8  | 45,6 | 38   | 38   | 8,7  | (4 x) UNC 5/16 x 1.1/4 |
| WFG 3002 JIC 1 1/16 U | 3000 PSI      | 350           | 3/4"          | UNF 1.1/16" 12 | 15,5 | 19   | 47,6 | 65   | 22,2 | 70,9  | 51,8 | 42   | 45   | 10,7 | (4 x) UNC 3/8 x 1.1/2  |
| WFG 3002 JIC 1 5/16 U | 3000 PSI      | 350           | 3/4"          | UN 1.5/16" -12 | 21,5 | 19   | 47,6 | 65   | 22,2 | 70,9  | 51,8 | 42   | 45   | 10,7 | (4 x) UNC 3/8 x 1.1/2  |
| WFG 3002 JIC 7/8 U    | 3000 PSI      | 350           | 3/4"          | UNF 7/8" -14   | 12,3 | 19   | 47,6 | 65   | 22,2 | 70,9  | 51,8 | 42   | 45   | 10,7 | (4 x) UNC 3/8 x 1.1/2  |
| WFG 3003 JIC 1 1/16 U | 3000 PSI      | 315           | 1"            | UNF 1.1/16" 12 | 15,5 | 24   | 52,4 | 70   | 26,2 | 79,2  | 58,4 | 45   | 50   | 10,7 | (4 x) UNC 3/8 x 1.1/2  |
| WFG 3003 JIC 1 5/16 U | 3000 PSI      | 315           | 1"            | UN 1.5/16" -12 | 21,5 | 24   | 52,4 | 70   | 26,2 | 79,2  | 58,4 | 45   | 50   | 10,7 | (4 x) UNC 3/8 x 1.1/2  |
| WFG 3003 JIC 1 5/8 U  | 3000 PSI      | 315           | 1"            | UN 1.5/8" -12  | 27,5 | 24   | 52,4 | 70   | 26,2 | 79,2  | 58,4 | 45   | 50   | 10,7 | (4 x) UNC 3/8 x 1.1/2  |
| WFG 3004 JIC 1 5/16 U | 3000 PSI      | 250           | 1.1/4"        | UN 1.5/16" -12 | 21,5 | 31   | 58,7 | 79   | 30,2 | 85,3  | 72,6 | 50   | 59   | *1   | (4 x) UNC 7/16 x 1.1/2 |
| WFG 3004 JIC 1 5/8 U  | 3000 PSI      | 250           | 1.1/4"        | UN 1.5/8" -12  | 27,5 | 31   | 58,7 | 79   | 30,2 | 85,3  | 72,6 | 50   | 59   | *1   | (4 x) UNC 7/16 x 1.1/2 |
| WFG 3005 JIC 1 5/8 U  | 3000 PSI      | 200           | 1.1/2"        | UN 1.5/8" -12  | 27,5 | 38   | 69,9 | 94   | 35,7 | 117,1 | 82,2 | 76   | 76   | 13,5 | (4 x) UNC 1/2 x 1,3/4  |
| WFG 3005 JIC 1 7/8 U  | 3000 PSI      | 200           | 1.1/2"        | UN 1.7/8" -12  | 33,0 | 38   | 69,9 | 94   | 35,7 | 117,1 | 82,2 | 76   | 76   | 13,5 | (4 x) UNC 1/2 x 1,3/4  |
|                       |               |               |               |                |      |      |      |      |      |       |      |      |      |      |                        |
| WFG 6001 JIC 3/4 U    | 6000 PSI      | 400           | 1/2"          | UNF 3/4" -16   | 9,9  | 13   | 40,5 | 56   | 18,2 | 61,6  | 47,2 | 39   | 38   | 8,7  | (4 x) UNC 5/16 x 1.1/4 |
| WFG 6001 JIC 7/8 U    | 6000 PSI      | 400           | 1/2"          | UNF 7/8" -14   | 12,3 | 13   | 40,5 | 56   | 18,2 | 61,6  | 47,2 | 39   | 38   | 8,7  | (4 x) UNC 5/16 x 1.1/4 |
| WFG 6002 JIC 1 1/16 U | 6000 PSI      | 400           | 3/4"          | UNF 1.1/16" 12 | 15,5 | 17   | 50,8 | 71   | 23,8 | 78,0  | 60,0 | 48   | 48   | 10,7 | (4 x) UNC 3/8 x 1.1/2  |
| WFG 6002 JIC 1 5/16 U | 6000 PSI      | 400           | 3/4"          | UN 1.5/16" -12 | 21,5 | 17   | 50,8 | 71   | 23,8 | 78,0  | 60,0 | 48   | 48   | 10,7 | (4 x) UNC 3/8 x 1.1/2  |
| WFG 6002 JIC 7/8 U    | 6000 PSI      | 400           | 3/4"          | UNF 7/8" -14   | 12,3 | 17   | 50,8 | 71   | 23,8 | 78,0  | 60,0 | 48   | 48   | 10,7 | (4 x) UNC 3/8 x 1.1/2  |
| WFG 6003 JIC 1 1/16 U | 6000 PSI      | 400           | 1"            | UNF 1.1/16" 12 | 15,5 | 24   | 57,2 | 81   | 27,8 | 99,0  | 69,9 | 60   | 60   | *2   | (4 x) UNC 7/16 x 1,3/4 |
| WFG 6003 JIC 1 5/16 U | 6000 PSI      | 400           | 1"            | UN 1.5/16" -12 | 21,5 | 24   | 57,2 | 81   | 27,8 | 99,0  | 69,9 | 60   | 60   | *2   | (4 x) UNC 7/16 x 1,3/4 |
| WFG 6003 JIC 1 5/8 U  | 6000 PSI      | 400           | 1"            | UN 1.5/8" -12  | 27,5 | 24   | 57,2 | 81   | 27,8 | 99,0  | 69,9 | 60   | 60   | *2   | (4 x) UNC 7/16 x 1,3/4 |
| WFG 6004 JIC 1 5/16 U | 6000 PSI      | 400           | 1.1/4"        | UN 1.5/16" -12 | 21,5 | 30   | 66,7 | 95   | 31,8 | 115,5 | 77,2 | 68   | 68   | *3   | (4 x) UNC 1/2 x 1,3/4  |
| WFG 6004 JIC 1 5/8 U  | 6000 PSI      | 400           | 1.1/4"        | UN 1.5/8" -12  | 27,5 | 30   | 66,7 | 95   | 31,8 | 115,5 | 77,2 | 68   | 68   | *3   | (4 x) UNC 1/2 x 1,3/4  |
| WFG 6004 JIC 1 7/8 U  | 6000 PSI      | 400           | 1.1/4"        | UN 1.7/8" -12  | 33,0 | 30   | 66,7 | 95   | 31,8 | 115,5 | 77,2 | 68   | 68   | *3   | (4 x) UNC 1/2 x 1,3/4  |
| WFG 6005 JIC 1 5/8 U  | 6000 PSI      | 400           | 1.1/2"        | UN 1.5/8" -12  | 27,5 | 32   | 79,4 | 113  | 36,5 | 133,0 | 95,0 | 76   | 76   | 17,0 | (4 x) UNC 5/8 x 2      |
| WFG 6005 JIC 1 7/8 U  | 6000 PSI      | 400           | 1.1/2"        | UN 1.7/8" -12  | 33,0 | 32   | 79,4 | 113  | 36,5 | 133,0 | 95,0 | 76   | 76   | 17,0 | (4 x) UNC 5/8 x 2      |

Serija: LL = labai lengvas L = lengvas S = sunkus - Ø = išorinis vamzdžio skersmuo - PN = nominalusis slėgis PB = maks. darbinis slėgis

\*1) = pasirinktinai 10,5, 12,0 arba 12,5 - \*2) = pasirinktinai 12,0 arba 12,5 - \*3) = pasirinktinai 13,5 arba 14,5

## Gaminių variantai

|                                    |  |
|------------------------------------|--|
| <b>WFG JIC (6000 PSI)</b>          | SAE flanšinis adapteris, nukaltas, tik flanšas   |
| <b>WFG JIC M (3000 / 6000 PSI)</b> | SAE flanšinis adapteris, nukaltas, su 2 flanšų pusėmis, varžtų rinkiniu ir sandarinimo žiedu |