

KLEMMSCHEL

Clamp, Aluminium

HANSA FLEX

Savybės

| | |
|--------------------------------|--------------------------------------------------|
| Panaudojimas | Clamping components for small flange connections |
| Konstrukcija | Clamp aluminium |
| Norma | DIN 28403 ISO 2861 |
| Medžiaga | Aluminis |
| Temperatūros diapazonas | Aluminis nuo -156 °C iki 150 °C |

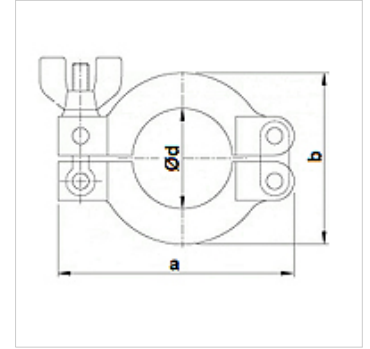

Nuoroda

Slėgio diapazonas nuo 10–7 mbar iki 2,5 bar

užsakymo nuorodos

Kiti modeliai pagal užklausą

Prekė

| Pavadinimas | Plotis (mm) | a (mm) | b (mm) | Ø d (mm) |
|-------------------|-------------|--------|--------|----------|
| KLEMMSCHEL 010/16 | 17,0 | 63,0 | 45,0 | 22,0 |
| KLEMMSCHEL 020/25 | 17,0 | 73,0 | 52,0 | 32,0 |
| KLEMMSCHEL 032/40 | 17,0 | 93,0 | 70,0 | 47,0 |
| KLEMMSCHEL 050 | 22,0 | 114,0 | 95,0 | 62,0 |