

K-DRV

Unidirectional flow control valves

HANSA FLEX

Savybės

| | |
|---------------------|--------------|
| Darbinis slėgis | maks. 10 bar |
| Darbinė temperatūra | max. +70 °C |
| Sandarinio medžiaga | NBR |
| Korpusas | Alu eloxed |
| Vidinės dalys | Brass |

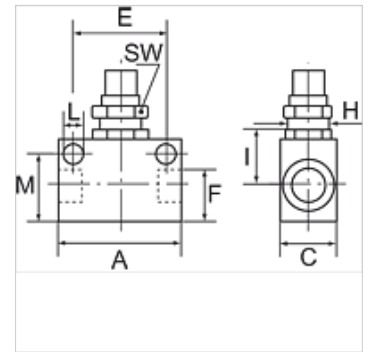

Nuoroda

Daugiau duomenų pagal užklausimą.

Aprašas

These valves are restricted in the flow direction and have free passage in the opposite direction.

Prekė

| Pavadinimas | Sriegis | A (mm) | C (mm) | E (mm) | H matmuo | I (mm) | L (mm) | M (mm) | SW (mm) |
|----------------|---------|-----------|-----------|-----------|----------------|-----------|-----------|-----------|------------|
| K- 07 30 12 36 | M 5 | 25,0 | 12,0 | 18,0 | M 9 x 0.75 mm | 10,0 | 3,2 | 12,2 | 11 |
| K- 07 30 12 37 | G 1/8 | 34,0 | 16,0 | 24,0 | M 12 x 0.75 mm | 15,0 | 4,5 | 16,4 | 15 |
| K- 07 30 12 38 | G 1/4 | 50,0 | 25,0 | 35,0 | M 18 x 1.5 mm | 24,0 | 6,5 | 23,8 | 22 |
| K- 07 30 12 39 | G 3/8 | 58,0 | 25,0 | 40,0 | M 18 x 1.5 mm | 24,0 | 6,5 | 25,3 | 22 |
| K- 07 30 12 40 | G 1/2 | 65,0 | 30,0 | 50,0 | M 22 x 1.5 mm | 29,0 | 6,5 | 33,0 | 26 |