

K-DRS ELK GERAETESTECKER

Pressure switches, connection with plug connector, type A acc. to DIN 43650

HANSA FLEX

Savybės

Taikymo sritis	Pneumatic applications
Komutavimų dažnis	200/min.
Paskirstymo įtampa	max. 250 V AC / 28 V DC
Apsaugos rūšis	IP 65 (DIN 43650), IP 67 (M 12 x 1)
Temperatūros diapazonas	-10 °C to +80 °C
Reguliavimo gaubtelis	Aluminium, powder-coated
Korpusas	Special die-cast material
Membrana, sandariklis	NBR

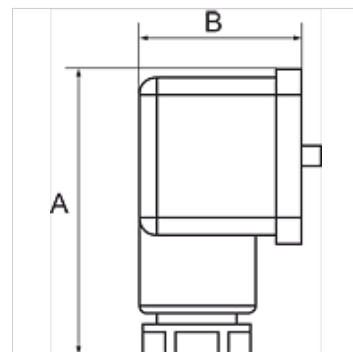

Nuoroda

Daugiau duomenų pagal užklausimą.

Aprašas

For converting pneumatic to electrical signals. Designed for use in rough vacuum applications (technical vacuum). Universal switch type, suitable as NC, NO or changeover contact. These devices are free from paint-wetting impairment substances (PWIS).

Prekė

Pavadinimas	Jungtis	Nustatymo diapazonas	A (mm)	B (mm)
K- 07 30 28 45	G 1/4	0,2 - 2,0 bar	48,0	28,0
K- 07 30 28 46	G 1/4	0,5 - 8,0 bar	48,0	28,0
K- 07 30 28 47	G 1/4	1,0 - 16,0 bar	48,0	28,0