

K-DRS ELK ANSCHLUSS M 1

Pressure switches, electrical connection M 12 x 1

Savybės

| | |
|-------------------------|-------------------------------------|
| Taikymo sritis | Pneumatic applications |
| Komutavimų dažnis | 200/min. |
| Paskirstymo įtampa | max. 250 V AC / 28 V DC |
| Apsaugos rūšis | IP 65 (DIN 43650), IP 67 (M 12 x 1) |
| Temperatūros diapazonas | -10 °C to +80 °C |
| Reguliavimo gaubtelis | Aluminium, powder-coated |
| Korpusas | Special die-cast material |
| Membrana, sandariklis | NBR |

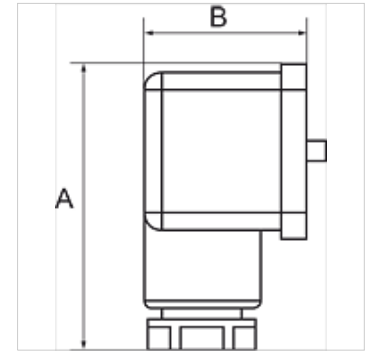

Nuoroda

Daugiau duomenų pagal užklausimą.

Aprašas

For converting pneumatic to electrical signals. Designed for use in rough vacuum applications (technical vacuum). Universal switch type, suitable as NC, NO or changeover contact. These devices are free from paint-wetting impairment substances (PWIS).

Prekė

| Pavadinimas | Jungtis | Nustatymo diapazonas | A (mm) | B (mm) |
|----------------|---------|----------------------|-----------|-----------|
| K- 07 30 28 48 | G 1/4 | 0,2 - 2,0 bar | 48,0 | 28,0 |
| K- 07 30 28 49 | G 1/4 | 0,5 - 8,0 bar | 48,0 | 28,0 |
| K- 07 30 28 50 | G 1/4 | 1,0 - 16,0 bar | 48,0 | 28,0 |