

K-BKR ANTR D FEDER MS

Brass ball valves, single-acting actuator - spring to close

HANSA FLEX

Savybės

Konstrukcija	Pneumatic, double-piston, part-turn actuator, double-rocker principle
Darbinis slėgis	Max. 16 bar
Darbinė temperatūra	-20 °C to +150 °C
Sukimo kampas	90 °
Valdymo slėgis	5.6 bar
Vožtuvo adapteris	Supplied as standard
Temperatūros diapazonas	-20 °C to +80 °C
Pavara	aluminium eloxed
Pavaros sandariklis	NBR
Rutulinis vožtuvas	Chrome-plated brass, with ISO-flange plate
Rutulinio vožtuvo tarpiklis	PTFE/FKM

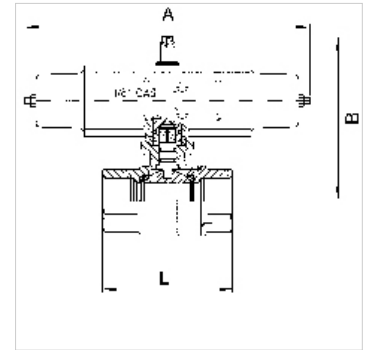
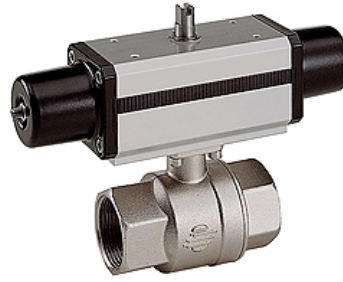

Nuoroda

Daugiau duomenų pagal užklausimą.

Prekė

Pavadinimas	DN	Sriegis	A (mm)	B (mm)	L (mm)
K- 07 30 02 35	10	Rp 3/8	221,0	110,0	69,0
K- 07 30 02 36	15	Rp 1/2	221,0	110,0	69,0
K- 07 30 02 37	20	Rp 3/4	221,0	117,0	77,0
K- 07 30 02 38	25	Rp 1	221,0	121,0	89,0
K- 07 30 02 39	32	Rp 1 1/4	221,0	131,0	103,0
K- 07 30 02 40	40	Rp 1 1/2	221,0	137,0	114,0
K- 07 30 02 41	50	Rp 2	240,0	155,0	134,0