

K-XV RD 6-KANT

Double nipples, unequal, hexagonal

HANSA FLEX

Savybės

| | |
|------------------|------------------------------|
| Darbinis slėgis | Max. 20 bar |
| Sriegiai išorėje | Parallel to DIN EN ISO 228-1 |
| Medžiaga | Stainless steel 1.4408 |

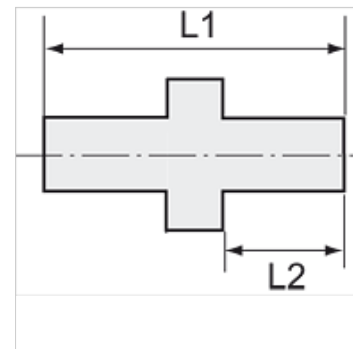
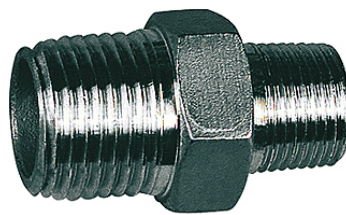

Nuoroda

The dimensions of the standard screw fittings may change slightly during the life of the catalogue as a result of optimisation processes.

Daugiau duomenų pagal užklausimą.

Prekė

| Pavadinimas | 1 sriegiai išorėje | 2 sriegiai išorėje | L1 (mm) | L2 (mm) | SW (rakto dydis) |
|----------------|--------------------|--------------------|------------|------------|------------------|
| K- 07 40 12 27 | G 1/4 | G 1/8 | 30,4 | 11,0 | 15 mm |
| K- 07 40 12 28 | G 3/8 | G 1/8 | 34,2 | 12,0 | 20 mm |
| K- 07 40 12 29 | G 3/8 | G 1/4 | 35,8 | 12,8 | 20 mm |
| K- 07 40 12 30 | G 1/2 | G 1/4 | 38,0 | 13,0 | 24 mm |
| K- 07 40 12 31 | G 1/2 | G 3/8 | 40,0 | 15,0 | 24 mm |
| K- 07 40 12 32 | G 3/4 | G 3/8 | 41,0 | 16,0 | 27 mm |
| K- 07 40 12 33 | G 3/4 | G 1/2 | 42,9 | 16,0 | 29 mm |
| K- 07 40 12 34 | G 1 | G 1/2 | 46,0 | 17,0 | 36 mm |
| K- 07 40 12 35 | G 1 | G 3/4 | 46,0 | 16,5 | 36 mm |
| K- 07 40 12 36 | G 1 1/4 | G 3/4 | 50,0 | 17,5 | 45 mm |
| K- 07 40 12 37 | G 1 1/4 | G 1 | 51,0 | 18,5 | 45 mm |
| K- 07 40 12 38 | G 1 1/2 | G 1 | 52,0 | 18,5 | 51 mm |
| K- 07 40 12 39 | G 1 1/2 | G 1 1/4 | 55,0 | 20,7 | 51 mm |
| K- 07 40 12 40 | G 2 | G 1 | 58,0 | 20,0 | 62 mm |
| K- 07 40 12 41 | G 2 | G 1 1/2 | 60,0 | 21,5 | 63 mm |