

K-W90 SCHLAUCH VB

Elbow hose connectors

HANSA FLEX

Savybės

Darbinis slėgis	Dependent on operating temperature; Max. 10 bar (at 20 °C); Max. 1 bar (at 60 °C)
Srieginės jungties korpusas	Polyamide (PA)
Suveržimo žiedas	Polypropylene (PP)
Veržlė	Polypropylene (PP)

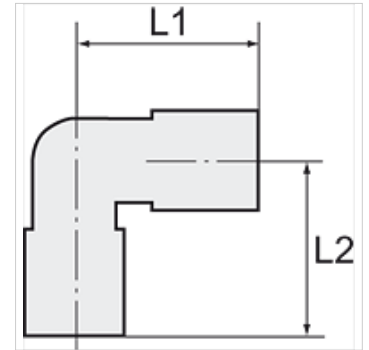

Nuoroda

Daugiau duomenų pagal užklausimą.

Aprašas

Manufactured from high impact-resistant, UV-stabilised engineering plastic, extremely resistant to weathering. Good chemical resistance to benzine, diesel oil, fuel oil and alkalis.
Not suitable for use with acids.

Prekė

Pavadinimas	žarnai	L1 (mm)	L2 (mm)
K- 07 40 32 66	4 mm / 6 mm	25,0	25,0
K- 07 40 32 67	6 mm / 8 mm	30,0	30,0
K- 07 40 32 68	8 mm / 10 mm	36,0	36,0
K- 07 40 32 69	9 mm / 12 mm	43,0	43,0