

K-XV AGM 2

Double nipples, parallel male thread

HANSA FLEX

Savybės

Darbinis slėgis	10 bar
Medžiagos temperatūra	max. +90 °C
Aplinkos temperatūra	Max. +90 °C
Medžiaga	Brass with a bare metal surface

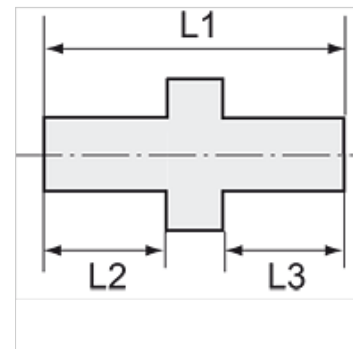
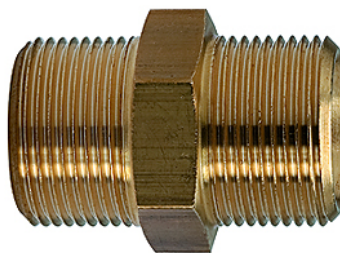

Nuoroda

The dimensions of the standard screw fittings may change slightly during the life of the catalogue as a result of optimisation processes. Daugiau duomenų pagal užklausimą.

Papildoma informacija

Further types and dimensions on request.

Prekė

Pavadinimas	1 sriegiai	2 sriegiai	L1 (mm)	L2 (mm)	L3 (mm)	SW (rakto dydis)
K- 07 35 11 26	M 14 x 1.5	M 14 x 1.5	23,0	9,0	9,0	17 mm
K- 07 35 11 27	M 16 x 1.5	M 16 x 1.5	23,0	9,0	9,0	19 mm
K- 07 35 11 28	M 24 x 1.5	M 24 x 1.5	40,0	16,0	16,0	27 mm
K- 07 40 00 04	M 5	M 5	13,0	5,0	5,0	7 mm
K- 07 40 00 05	M 5	G 1/8	17,0	5,0	7,0	14 mm
K- 07 40 00 06	M 5	G 1/4	21,0	7,0	9,0	17 mm
K- 07 40 00 01	G 1/8	G 1/8	21,0	8,0	8,0	14 mm
K- 07 40 00 02	G 1/8	G 1/4	22,0	9,0	8,0	17 mm
K- 07 40 00 03	G 1/8	G 3/8	25,0	9,0	11,0	19 mm
K- 07 40 00 07	G 1/4	G 1/4	23,0	9,0	9,0	17 mm
K- 07 40 00 31	G 1/4 ccw	G 1/4 ccw	25,0	10,0	10,0	17 mm
K- 07 40 00 08	G 1/4	G 3/8	24,0	9,0	10,0	19 mm
K- 07 40 00 09	G 1/4	G 1/2	29,0	11,0	12,0	24 mm
K- 07 40 00 10	G 3/8	G 3/8	25,0	10,0	10,0	19 mm
K- 07 40 00 32	G 3/8 ccw	G 3/8 ccw	37,0	13,5	13,5	19 mm
K- 07 40 00 11	G 3/8	G 1/2	27,0	10,0	12,0	24 mm
K- 07 40 00 12	G 3/8	G 3/4	36,0	12,0	16,0	32 mm
K- 07 40 00 13	G 1/2	G 1/2	29,0	12,0	12,0	24 mm
K- 07 40 00 14	G 1/2	G 3/4	33,0	12,0	12,0	32 mm
K- 07 40 00 15	G 1/2	G 1	40,0	16,0	16,0	36 mm
K- 07 40 00 16	G 3/4	G 3/4	33,0	12,0	12,0	32 mm
K- 07 40 00 17	G 3/4	G 1	40,0	16,0	16,0	36 mm
K- 07 40 00 18	G 1	G 1	42,5	17,0	17,0	36 mm
K- 07 40 00 19	G 1	G 1 1/4	32,0	14,0	12,0	42 mm
K- 07 40 00 20	G 1	G 1 1/2	39,0	14,5	14,5	50 mm
K- 07 40 44 36	G 1	G 2	42,0	18,0	15,0	60 mm
K- 07 40 00 21	G 1 1/4	G 1 1/4	39,0	16,0	16,0	42 mm
K- 07 40 00 22	G 1 1/4	G 1 1/2	40,5	15,0	18,0	50 mm
K- 07 40 44 37	G 1 1/4	G 2	43,0	29,5	29,5	60 mm
K- 07 40 00 23	G 1 1/2	G 1 1/2	50,0	20,0	20,0	50 mm
K- 07 40 00 24	G 1 1/2	G 2	43,0	17,0	17,0	62 mm
K- 07 40 00 25	G 2	G 2	50,0	20,0	20,0	62 mm
K- 07 40 44 38	G 2	G 2 1/2	54,0	24,0	19,0	77 mm
K- 07 40 44 39	G 2	G 3	50,0	20,0	20,0	89 mm
K- 07 40 44 40	G 2 1/2	G 2 1/2	59,0	24,0	24,0	77 mm
K- 07 40 44 41	G 2 1/2	G 3	52,5	20,0	22,5	89 mm
K- 07 40 44 42	G 3	G 3	60,0	24,5	24,5	89 mm