

K-L-STECKVER L DREH AG OR

Male elbows, long, swivel type, parallel male thread with O-ring

HANSA FLEX

Savybės

| | |
|-------------------------|--|
| Darbinis slėgis | Max. 15 bar, coarse vacuum |
| Taikymo sritys | Air, vacuum |
| rekomenduojamos žarnos | PU or PA (nylon) |
| Medžiagos | Compressed air and all gases or liquids that are compatible with the materials |
| Temperatūros diapazonas | -20 °C to +80 °C |
| Sandarinimo paviršius | Parallel version: O-ring in housing |
| Medžiaga | Plastic, Nickel plated brass |
| Prispaudimo žiedas | Plastic |

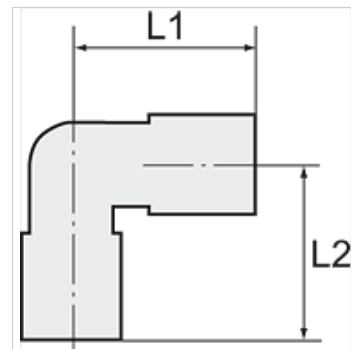

Nuoroda

Daugiau duomenų pagal užklausimą.

Aprašas

Push-in fittings series manufactured in plastic and nickel-plated brass. All parts are suitable for use with hoses, tubes or pipes made of plastic and copper.

Prekė

| Pavadinimas | Sriegis | žarnos išoriniam Ø | L1 (mm) | L2 (mm) | SW (rakto dydis) |
|----------------|---------|--------------------|---------|---------|------------------|
| K- 07 40 01 76 | M 5 | 4 mm | 18,8 | 32,5 | 8 mm |
| K- 07 40 01 77 | M 5 | 6 mm | 20,0 | 33,5 | 8 mm |
| K- 07 40 01 90 | G 1/8 | 4 mm | 18,8 | 30,5 | 14 mm |
| K- 07 40 01 91 | G 1/8 | 6 mm | 20,0 | 31,5 | 14 mm |
| K- 07 40 01 92 | G 1/8 | 8 mm | 22,5 | 37,8 | 14 mm |
| K- 07 40 01 88 | G 1/8 | 10 mm | 26,9 | 45,4 | 17 mm |
| K- 07 40 01 89 | G 1/8 | 12 mm | 28,5 | 46,9 | 17 mm |
| K- 07 40 01 85 | G 1/4 | 4 mm | 18,8 | 30,5 | 17 mm |
| K- 07 40 01 86 | G 1/4 | 6 mm | 20,0 | 31,5 | 17 mm |
| K- 07 40 01 87 | G 1/4 | 8 mm | 22,5 | 33,8 | 17 mm |
| K- 07 40 01 83 | G 1/4 | 10 mm | 26,9 | 46,4 | 17 mm |
| K- 07 40 01 84 | G 1/4 | 12 mm | 28,5 | 47,9 | 17 mm |
| K- 07 40 01 96 | G 3/8 | 6 mm | 20,0 | 32,6 | 20 mm |
| K- 07 40 01 97 | G 3/8 | 8 mm | 22,5 | 34,9 | 20 mm |
| K- 07 40 01 93 | G 3/8 | 10 mm | 26,9 | 43,4 | 20 mm |
| K- 07 40 01 94 | G 3/8 | 12 mm | 28,5 | 44,9 | 20 mm |
| K- 07 40 01 95 | G 3/8 | 16 mm | 33,5 | 58,2 | 20 mm |
| K- 07 40 01 81 | G 1/2 | 6 mm | 20,0 | 33,3 | 24 mm |
| K- 07 40 01 82 | G 1/2 | 8 mm | 22,5 | 37,3 | 24 mm |
| K- 07 40 01 78 | G 1/2 | 10 mm | 26,9 | 45,3 | 24 mm |
| K- 07 40 01 79 | G 1/2 | 12 mm | 28,5 | 46,8 | 24 mm |
| K- 07 40 01 80 | G 1/2 | 16 mm | 33,5 | 54,9 | 24 mm |