

# K-L-STECKVER DREH AG OR VA

Male elbows, swivel type, parallel male thread with O-ring

**HANSA FLEX**

## Savybės

Pulsuojantis darbinis slėgis	Max. 10 bar
Slėgis	Max. 15 bar (depending on pipe quality)
Tinkama žaliava	PVDF, PTFE, stainless steel, PA, PU
Norma	G thread acc. to DIN EN ISO 228-1, with O-Ring
Aplinkos temperatūra	-20 °C to max. +150 °C (depending on pipe quality and diameter)
Medžiaga	nerūdijantis plienas 1.4404
Sandarinio medžiaga	FKM

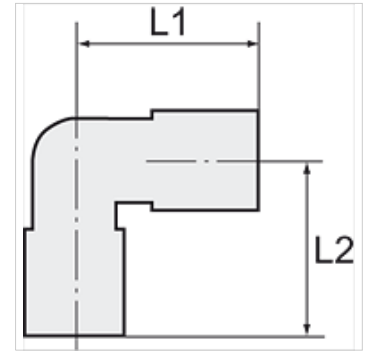
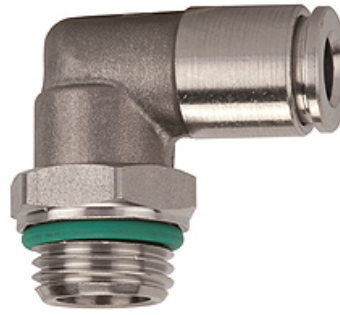

## Nuoroda

Daugiau duomenų pagal užklausimą.

## Aprašas

For use with aggressive media and in areas with corrosive outside influences, in the food processing industry and in hygienic and sanitary applications.

## Prekė

Pavadinimas	Sriegis	žarnos išoriniam Ø	L1 (mm)	L2 (mm)	SW (rakto dydis)
K- 07 40 46 76	M 5	4 mm	17,0	14,0	9 mm
K- 07 40 23 91	G 1/8	4 mm	17,0	16,0	13 mm
K- 07 40 23 93	G 1/8	8 mm	22,0	18,0	13 mm
K- 07 40 23 92	G 1/8	6 mm	21,5	18,0	13 mm
K- 07 40 23 89	G 1/4	6 mm	21,5	20,0	16 mm
K- 07 40 23 90	G 1/4	8 mm	22,0	20,0	16 mm
K- 07 40 23 88	G 1/4	10 mm	25,5	22,5	16 mm
K- 07 40 23 94	G 3/8	10 mm	25,5	24,0	21 mm
K- 07 40 23 95	G 3/8	12 mm	28,0	26,5	21 mm
K- 07 40 23 87	G 1/2	12 mm	28,0	31,0	22 mm