

K-L-STECKVER DREH AG-K

Male elbows, swivel type, conical male thread

HANSA FLEX

Savybės

Darbinis slėgis Max. 16 bar

Darbinė temperatūra -20 °C to +80 °C

Medžiaga Žalvaris, nikeliuotas

Prispaudimo žiedas Hostaform

Įtempimo žiedas Stainless steel

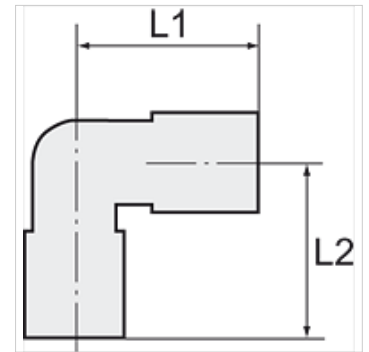

Nuoroda

Daugiau duomenų pagal užklausimą.

Aprašas

The advanced version of our highly successful push-in fittings series manufactured in nickel-plated brass. Advantages of this new, optimised series: Much easier connection and disconnection of the hose, even with repeated mounting, can also be used for non-calibrated hoses, suitable for vacuum operation.

Prekė

Pavadinimas	Sriegis	žarnos išoriniam Ø	L1 (mm)	L2 (mm)	SW (rakto dydis)
K- 07 40 27 08	R 1/8	4 mm	18,6	19,8	12 mm
K- 07 40 27 09	R 1/8	6 mm	21,9	19,8	12 mm
K- 07 40 27 10	R 1/8	8 mm	25,4	19,8	12 mm
K- 07 40 27 05	R 1/4	4 mm	18,6	22,6	14 mm
K- 07 40 27 06	R 1/4	6 mm	21,9	22,6	14 mm
K- 07 40 27 07	R 1/4	8 mm	25,4	23,6	14 mm
K- 07 40 27 04	R 1/4	10 mm	27,2	26,3	14 mm
K- 07 40 27 13	R 3/8	8 mm	23,6	27,1	17 mm
K- 07 40 27 11	R 3/8	10 mm	27,2	27,1	17 mm
K- 07 40 27 12	R 3/8	12 mm	30,0	27,1	17 mm
K- 07 40 27 03	R 1/2	12 mm	30,0	31,9	22 mm