

# K-T-MEHRF-VERT 6 DREH 1

Tee distributors with inner hex, 6 outlets, swivel type, parallel male thread with O-ring

**HANSA FLEX**

## Savybės

<b>Darbinis slėgis</b>	Max. 15 bar, coarse vacuum
<b>Taikymo sritys</b>	Air, vacuum
<b>rekomenduojamos žarnos</b>	PU or PA (nylon)
<b>Medžiagos</b>	Compressed air and all gases or liquids that are compatible with the materials
<b>Temperatūros diapazonas</b>	-20 °C to +80 °C
<b>Sandarinimo paviršius</b>	Parallel version: O-ring in housing
<b>Medžiaga</b>	Plastic, Nickel plated brass
<b>Prispaudimo žiedas</b>	Plastic

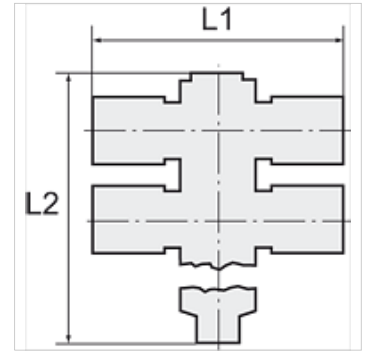

## Nuoroda

Daugiau duomenų pagal užklausimą.

## Aprašas

Push-in fittings series manufactured in plastic and nickel-plated brass. All parts are suitable for use with hoses, tubes or pipes made of plastic and copper.

## Prekė

Pavadinimas	Sriegis	žarnos išoriniam Ø	Vidinis šešiabriaunis (mm)	L1 (mm)	L2 (mm)	SW (rakto dydis)
K- 07 40 06 70	G 1/8	4 mm	4,0	45,0	59,1	14 mm
K- 07 40 06 71	G 1/8	6 mm	4,0	42,6	59,1	14 mm
K- 07 40 06 72	G 1/8	8 mm	4,0	48,5	59,1	14 mm
K- 07 40 06 68	G 1/4	6 mm	6,0	46,7	80,5	17 mm
K- 07 40 06 69	G 1/4	8 mm	6,0	52,5	80,5	17 mm
K- 07 40 06 66	G 1/4	10 mm	6,0	59,6	80,5	17 mm
K- 07 40 06 67	G 1/4	12 mm	6,0	61,2	80,5	17 mm
K- 07 40 06 75	G 3/8	8 mm	8,0	56,7	82,2	20 mm
K- 07 40 06 73	G 3/8	10 mm	8,0	63,5	82,2	20 mm
K- 07 40 06 74	G 3/8	12 mm	8,0	64,9	82,2	20 mm