

## Īpašības

|                  |  |
|------------------|--|
| Savienojums 1    | Metriskā ārējā vītne, cilindriska                        |
| Bīvējuma veids 1 | B veida  |
| Savienojums 2    | metriskā ārējās vītnes, cilindriskās                     |
| Bīvējuma veids 2 | 24° iekšējais konuss                                     |
| Modelis          | leskrūvējams veidgabals                                  |
| Konstrukcija     | Taisna   |
| Standarts        | DIN 2353<br>ISO 8434-1                                   |
| Piegādes apjoms  | lemava ar uznavuzgriezni un griešanas gredzenu           |
| Materiāls        | Centrējošais gredzens no alumīnija ar Viton gredzenblīvi |

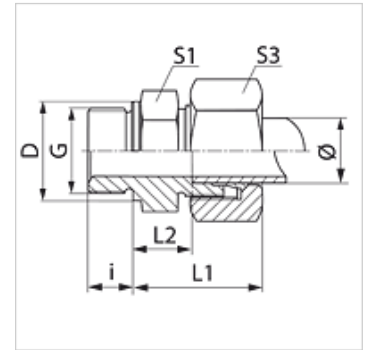

## Norāde

Norādes par montāžu, uzstādīšanu, spiediena noslodzi un pieļaujamo ekspluatācijas temperatūru norādītas cauruļu veidgabalu tehniskajā informācijā.

## Izstrādājums

| Apzīmējums        | Sērija | Ekspluatācijas spiediens bar | Caurules ārējais Ø (mm) | G          | D (mm) | i (mm) | L1 (mm) | L2 (mm) | S1 | S3 |
|-------------------|--------|------------------------------|-------------------------|------------|--------|--------|---------|---------|----|----|
| VM NW 04 HL VA    | L      | PN 315                       | 6                       | M 10 x 1   | 14     | 8,0    | 23,0    | 8,5     | 14 | 14 |
| VM NW 04 HL 12 VA | L      | PN 315                       | 6                       | M 12 x 1,5 | 17     | 12,0   | 25,0    | 10,0    | 17 | 14 |
| VM NW 04 HL 14 VA | L      | PN 315                       | 6                       | M 14 x 1,5 | 19     | 12,0   | 25,0    | 10,0    | 19 | 14 |
| VM NW 06 HL VA    | L      | PN 315                       | 8                       | M 12 x 1,5 | 17     | 12,0   | 25,0    | 10,0    | 17 | 17 |
| VM NW 06 HL 10 VA | L      | PN 315                       | 8                       | M 10 x 1   | 17     | 8,0    | 25,0    | 10,0    | 17 | 17 |
| VM NW 06 HL 14 VA | L      | PN 315                       | 8                       | M 14 x 1,5 | 19     | 12,0   | 25,0    | 10,0    | 19 | 17 |
| VM NW 06 HL 16 VA | L      | PN 315                       | 8                       | M 16 x 1,5 | 21     | 12,0   | 26,0    | 11,5    | 22 | 17 |
| VM NW 06 HL 18 VA | L      | PN 315                       | 8                       | M 18 x 1,5 | 23     | 12,0   | 26,0    | 11,5    | 24 | 17 |
| VM NW 08 HL VA    | L      | PN 315                       | 10                      | M 14 x 1,5 | 19     | 12,0   | 26,0    | 11,0    | 19 | 19 |
| VM NW 08 HL 10 VA | L      | PN 315                       | 10                      | M 10 x 1   | 14     | 8,0    | 26,0    | 11,0    | 17 | 19 |
| VM NW 08 HL 12 VA | L      | PN 315                       | 10                      | M 12 x 1,5 | 17     | 12,0   | 26,0    | 11,0    | 17 | 19 |
| VM NW 08 HL 16 VA | L      | PN 315                       | 10                      | M 16 x 1,5 | 22     | 12,0   | 27,5    | 12,5    | 22 | 19 |
| VM NW 08 HL 18 VA | L      | PN 315                       | 10                      | M 18 x 1,5 | 23     | 12,0   | 27,5    | 12,5    | 24 | 19 |
| VM NW 08 HL 22 VA | L      | PN 315                       | 10                      | M 22 x 1,5 | 27     | 14,0   | 29,0    | 14,0    | 27 | 19 |
| VM NW 10 HL VA    | L      | PN 315                       | 12                      | M 16 x 1,5 | 21     | 12,0   | 27,0    | 12,5    | 22 | 22 |
| VM NW 10 HL 12 VA | L      | PN 315                       | 12                      | M 12 x 1,5 | 17     | 12,0   | 26,0    | 11,0    | 19 | 22 |
| VM NW 10 HL 14 VA | L      | PN 315                       | 12                      | M 14 x 1,5 | 19     | 12,0   | 27,0    | 12,5    | 22 | 22 |
| VM NW 10 HL 18 VA | L      | PN 315                       | 12                      | M 18 x 1,5 | 23     | 12,0   | 27,0    | 12,5    | 24 | 22 |
| VM NW 10 HL 22 VA | L      | PN 315                       | 12                      | M 22 x 1,5 | 27     | 14,0   | 28,5    | 14,0    | 27 | 22 |
| VM NW 13 HL VA    | L      | PN 315                       | 15                      | M 18 x 1,5 | 23     | 12,0   | 29,0    | 13,5    | 24 | 27 |
| VM NW 13 HL 16 VA | L      | PN 315                       | 15                      | M 16 x 1,5 | 21     | 12,0   | 29,0    | 13,5    | 24 | 27 |
| VM NW 13 HL 22 VA | L      | PN 315                       | 15                      | M 22 x 1,5 | 27     | 14,0   | 30,5    | 15,0    | 27 | 27 |
| VM NW 16 HL VA    | L      | PN 315                       | 18                      | M 22 x 1,5 | 27     | 14,0   | 31,0    | 14,5    | 27 | 32 |
| VM NW 16 HL 18 VA | L      | PN 315                       | 18                      | M 18 x 1,5 | 23     | 12,0   | 30,5    | 14,0    | 27 | 32 |
| VM NW 16 HL 26 VA | L      | PN 315                       | 18                      | M 26 x 1,5 | 31     | 16,0   | 31,0    | 14,5    | 32 | 32 |
| VM NW 20 HL VA    | L      | PN 160                       | 22                      | M 26 x 1,5 | 31     | 16,0   | 33,0    | 16,5    | 32 | 36 |
| VM NW 25 HL VA    | L      | PN 160                       | 28                      | M 33 x 2   | 39     | 18,0   | 34,0    | 17,5    | 41 | 41 |
| VM NW 32 HL VA    | L      | PN 160                       | 35                      | M 42 x 2   | 49     | 20,0   | 39,0    | 17,5    | 50 | 50 |
| VM NW 40 HL VA    | L      | PN 160                       | 42                      | M 48 x 2   | 55     | 22,0   | 42,0    | 19,0    | 55 | 60 |
| VM NW 03 HS VA    | S      | PN 400                       | 6                       | M 12 x 1,5 | 17     | 12,0   | 28,0    | 13,0    | 17 | 17 |
| VM NW 03 HS 14 VA | S      | PN 400                       | 6                       | M 14 x 1,5 | 19     | 12,0   | 30,0    | 15,0    | 19 | 17 |
| VM NW 03 HS 16 VA | S      | PN 400                       | 6                       | M 16 x 1,5 | 21     | 12,0   | 28,0    | 13,0    | 17 | 17 |
| VM NW 04 HS VA    | S      | PN 400                       | 8                       | M 14 x 1,5 | 19     | 12,0   | 30,0    | 15,0    | 19 | 19 |
| VM NW 06 HS VA    | S      | PN 400                       | 10                      | M 16 x 1,5 | 21     | 12,0   | 31,0    | 15,0    | 22 | 22 |
| VM NW 08 HS VA    | S      | PN 400                       | 12                      | M 18 x 1,5 | 23     | 12,0   | 33,0    | 17,0    | 24 | 24 |
| VM NW 08 HS 14 VA | S      | PN 400                       | 12                      | M 14 x 1,5 | 21     | 12,0   | 33,0    | 17,0    | 19 | 24 |
| VM NW 10 HS VA    | S      | PN 400                       | 14                      | M 20 x 1,5 | 25     | 14,0   | 37,0    | 19,0    | 27 | 27 |
| VM NW 13 HS VA    | S      | PN 400                       | 16                      | M 22 x 1,5 | 27     | 14,0   | 37,0    | 18,5    | 27 | 30 |
| VM NW 13 HS 18 VA | S      | PN 400                       | 16                      | M 18 x 1,5 | 23     | 12,0   | 37,0    | 18,5    | 27 | 30 |
| VM NW 16 HS VA    | S      | PN 400                       | 20                      | M 27 x 2   | 32     | 16,0   | 42,0    | 20,5    | 32 | 36 |
| VM NW 20 HS VA    | S      | PN 250                       | 25                      | M 33 x 2   | 39     | 18,0   | 47,0    | 23,0    | 41 | 46 |
| VM NW 25 HS VA    | S      | PN 160                       | 30                      | M 42 x 2   | 49     | 20,0   | 50,0    | 23,5    | 50 | 50 |



## Izstrādājums

| Apzīmējums     | Sērija | Ekspluatācijas spiediens bar | Caurules ārējais Ø<br>(mm) | G        | D<br>(mm) | i<br>(mm) | L1<br>(mm) | L2<br>(mm) | S1 | S3 |
|----------------|--------|------------------------------|----------------------------|----------|-----------|-----------|------------|------------|----|----|
| VM NW 32 HS VA | S      | PN 160                       | 38                         | M 48 x 2 | 55        | 22,0      | 57,0       | 26,0       | 55 | 60 |

Sērija: LL = ļoti vieglā L = vieglā S = smagā – PN = nominālais spiediens PB = maks. ekspluatācijas spiediens – Ø = caurules ārējais diametrs

## Izstrādājumu varianti

|        |   |
|--------|---|
| VM     | leskrūvējams veidgabals, Tērauds  |
| VM MG  | leskrūvējams veidgabals, Misiņš   |
| XVM VA | leskrūvējams veidgabals, Centrējošais gredzens no alumīnija ar Viton gredzenblīvi |