

K-W90 SVB

Bulkhead elbow couplings

Īpašības

Ekspluatācijas spiediens	Dependent on operating temperature; Max. 10 bar (at 20 °C); Max. 1 bar (at 60 °C)
Skrūvelements	Polyamide (PA)
Spīlgredzens	Polypropylene (PP)
Uzgrieznis	Polypropylene (PP)

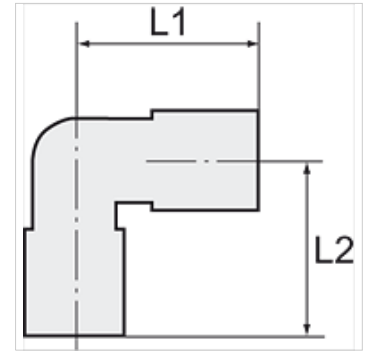
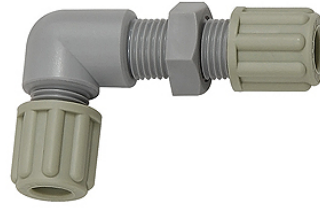

Norāde

Citi dati pieejami pēc pieprasījuma.

Apraksts

Manufactured from high impact-resistant, UV-stabilised engineering plastic, extremely resistant to weathering. Good chemical resistance to benzene, diesel oil, fuel oil and alkalis.
Not suitable for use with acids.

Izstrādājums

Apzīmējums	Vītnes	šļūtenei	L1 (mm)	L2 (mm)	SW
K- 07 40 32 78	M 10 x 1	4 mm / 6 mm	43,0	25,0	14 mm
K- 07 40 32 79	M 14 x 1,5	6 mm / 8 mm	53,0	33,0	19 mm
K- 07 40 32 80	M 16 x 1,5	8 mm / 10 mm	58,0	36,0	22 mm
K- 07 40 32 81	M 18 x 1,5	9 mm / 12 mm	67,0	43,0	24 mm