

K-XV AGM 2

Double nipples, parallel male thread

HANSA FLEX

Īpašības

| | |
|--------------------|---------------------------------|
| Darba spiediens | 10 bar |
| Vielas temperatūra | max. +90 °C |
| Vides temperatūra | Max. +90 °C |
| Materiāls | Brass with a bare metal surface |

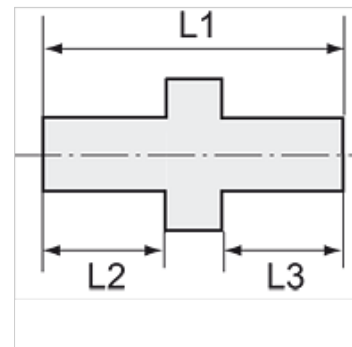
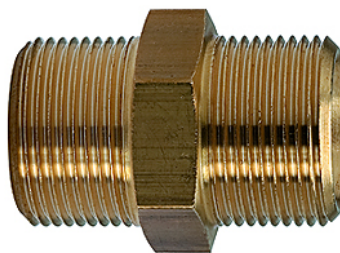

Norāde

The dimensions of the standard screw fittings may change slightly during the life of the catalogue as a result of optimisation processes.
Citi dati pieejami pēc pieprasījuma.

Papildu informācija

Further types and dimensions on request.

Izstrādājums

| Apzīmējums | Vītne 1 | Vītne 2 | L1 (mm) | L2 (mm) | L3 (mm) | SW |
|----------------|------------|------------|------------|------------|------------|-------|
| K- 07 35 11 26 | M 14 x 1.5 | M 14 x 1.5 | 23,0 | 9,0 | 9,0 | 17 mm |
| K- 07 35 11 27 | M 16 x 1.5 | M 16 x 1.5 | 23,0 | 9,0 | 9,0 | 19 mm |
| K- 07 35 11 28 | M 24 x 1.5 | M 24 x 1.5 | 40,0 | 16,0 | 16,0 | 27 mm |
| K- 07 40 00 04 | M 5 | M 5 | 13,0 | 5,0 | 5,0 | 7 mm |
| K- 07 40 00 05 | M 5 | G 1/8 | 17,0 | 5,0 | 7,0 | 14 mm |
| K- 07 40 00 06 | M 5 | G 1/4 | 21,0 | 7,0 | 9,0 | 17 mm |
| K- 07 40 00 01 | G 1/8 | G 1/8 | 21,0 | 8,0 | 8,0 | 14 mm |
| K- 07 40 00 02 | G 1/8 | G 1/4 | 22,0 | 9,0 | 8,0 | 17 mm |
| K- 07 40 00 03 | G 1/8 | G 3/8 | 25,0 | 9,0 | 11,0 | 19 mm |
| K- 07 40 00 07 | G 1/4 | G 1/4 | 23,0 | 9,0 | 9,0 | 17 mm |
| K- 07 40 00 31 | G 1/4 ccw | G 1/4 ccw | 25,0 | 10,0 | 10,0 | 17 mm |
| K- 07 40 00 08 | G 1/4 | G 3/8 | 24,0 | 9,0 | 10,0 | 19 mm |
| K- 07 40 00 09 | G 1/4 | G 1/2 | 29,0 | 11,0 | 12,0 | 24 mm |
| K- 07 40 00 10 | G 3/8 | G 3/8 | 25,0 | 10,0 | 10,0 | 19 mm |
| K- 07 40 00 32 | G 3/8 ccw | G 3/8 ccw | 37,0 | 13,5 | 13,5 | 19 mm |
| K- 07 40 00 11 | G 3/8 | G 1/2 | 27,0 | 10,0 | 12,0 | 24 mm |
| K- 07 40 00 12 | G 3/8 | G 3/4 | 36,0 | 12,0 | 16,0 | 32 mm |
| K- 07 40 00 13 | G 1/2 | G 1/2 | 29,0 | 12,0 | 12,0 | 24 mm |
| K- 07 40 00 14 | G 1/2 | G 3/4 | 33,0 | 12,0 | 12,0 | 32 mm |
| K- 07 40 00 15 | G 1/2 | G 1 | 40,0 | 16,0 | 16,0 | 36 mm |
| K- 07 40 00 16 | G 3/4 | G 3/4 | 33,0 | 12,0 | 12,0 | 32 mm |
| K- 07 40 00 17 | G 3/4 | G 1 | 40,0 | 16,0 | 16,0 | 36 mm |
| K- 07 40 00 18 | G 1 | G 1 | 42,5 | 17,0 | 17,0 | 36 mm |
| K- 07 40 00 19 | G 1 | G 1 1/4 | 32,0 | 14,0 | 12,0 | 42 mm |
| K- 07 40 00 20 | G 1 | G 1 1/2 | 39,0 | 14,5 | 14,5 | 50 mm |
| K- 07 40 44 36 | G 1 | G 2 | 42,0 | 18,0 | 15,0 | 60 mm |
| K- 07 40 00 21 | G 1 1/4 | G 1 1/4 | 39,0 | 16,0 | 16,0 | 42 mm |
| K- 07 40 00 22 | G 1 1/4 | G 1 1/2 | 40,5 | 15,0 | 18,0 | 50 mm |
| K- 07 40 44 37 | G 1 1/4 | G 2 | 43,0 | 29,5 | 29,5 | 60 mm |
| K- 07 40 00 23 | G 1 1/2 | G 1 1/2 | 50,0 | 20,0 | 20,0 | 50 mm |
| K- 07 40 00 24 | G 1 1/2 | G 2 | 43,0 | 17,0 | 17,0 | 62 mm |
| K- 07 40 00 25 | G 2 | G 2 | 50,0 | 20,0 | 20,0 | 62 mm |
| K- 07 40 44 38 | G 2 | G 2 1/2 | 54,0 | 24,0 | 19,0 | 77 mm |
| K- 07 40 44 39 | G 2 | G 3 | 50,0 | 20,0 | 20,0 | 89 mm |
| K- 07 40 44 40 | G 2 1/2 | G 2 1/2 | 59,0 | 24,0 | 24,0 | 77 mm |
| K- 07 40 44 41 | G 2 1/2 | G 3 | 52,5 | 20,0 | 22,5 | 89 mm |
| K- 07 40 44 42 | G 3 | G 3 | 60,0 | 24,5 | 24,5 | 89 mm |