

# K-FUSSBEFESTIGUNG 3

Foot model

**HANSA FLEX**

## Īpašības

Noteikumi ISO 15552

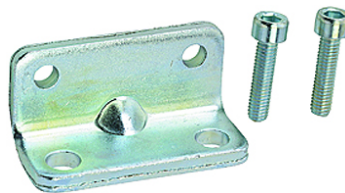

## Izstrādājums

Apzīmējums	Ø virzulim	Modelis
K- 07 15 21 52	32 mm	One foot with two screws
K- 07 15 21 82	40 mm	One foot with two screws
K- 07 15 21 83	50 mm	One foot with two screws
K- 07 15 21 84	63 mm	One foot with two screws
K- 07 15 21 87	125 mm	One foot with two screws

## ir piederums šādiem izstrādājumiem

K-NORMZYLINDER Standard cylinders