

K-VERSCHRAUBUNGEN PP

Unions - polypropylene

HANSA FLEX

Īpašības

| | |
|-----------------------------------|---|
| Ekspluatācijas spiediens | Dependent on operating temperature: Max. 10 bar (at 20 °C); Max. 2.5 bar (at 90 °C) |
| Materiāls | Polypropylene (PP) |
| Ekspluatācijas temperatūra | Max. 90 °C |

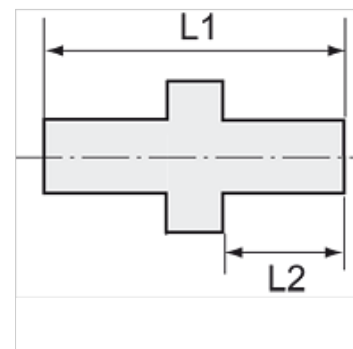
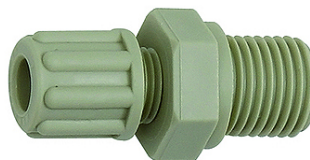

Norāde

Citi dati pieejami pēc pieprasījuma.

Apraksts

Chemically resistant to almost all inorganic acids and bases, even in high concentrations and at temperatures greater than 90 °C.

Izstrādājums

| Apzīmējums | Šļūtenei | Vītnes | L1 (mm) | L2 (mm) | SW |
|----------------|--------------|--------|------------|------------|-------|
| K- 07 40 40 96 | 4 mm / 6 mm | G 1/8 | 31,5 | 8,0 | 14 mm |
| K- 07 40 40 98 | 6 mm / 8 mm | G 1/8 | 36,5 | 8,0 | 17 mm |
| K- 07 40 41 00 | 8 mm / 10 mm | G 1/8 | 40,5 | 8,0 | 19 mm |
| K- 07 40 41 02 | 9 mm / 12 mm | G 1/8 | 44,5 | 8,0 | 22 mm |
| K- 07 40 41 03 | 4 mm / 6 mm | G 1/4 | 37,0 | 12,0 | 17 mm |
| K- 07 40 41 05 | 6 mm / 8 mm | G 1/4 | 41,0 | 12,0 | 17 mm |
| K- 07 40 41 07 | 8 mm / 10 mm | G 1/4 | 45,0 | 12,0 | 19 mm |
| K- 07 40 41 09 | 9 mm / 12 mm | G 1/4 | 49,0 | 12,0 | 22 mm |
| K- 07 40 41 11 | 4 mm / 6 mm | G 3/8 | 38,5 | 12,0 | 22 mm |
| K- 07 40 41 13 | 6 mm / 8 mm | G 3/8 | 42,5 | 12,0 | 22 mm |
| K- 07 40 41 15 | 8 mm / 10 mm | G 3/8 | 45,5 | 12,0 | 22 mm |
| K- 07 40 41 17 | 9 mm / 12 mm | G 3/8 | 49,5 | 12,0 | 22 mm |
| K- 07 40 41 19 | 4 mm / 6 mm | G 1/2 | 43,0 | 14,0 | 27 mm |
| K- 07 40 41 21 | 6 mm / 8 mm | G 1/2 | 47,0 | 14,0 | 27 mm |
| K- 07 40 41 23 | 8 mm / 10 mm | G 1/2 | 50,0 | 14,0 | 27 mm |
| K- 07 40 41 25 | 9 mm / 12 mm | G 1/2 | 54,0 | 14,0 | 27 mm |