

K-W TUE VB POM

Union elbows

HANSA FLEX

Īpašības

Darba spiediens	0 - 16 bar (4 - 8 mm); 0 - 10 bar (10 - 28 mm)
Ekspluatācijas temperatūra	-20 °C to +70 °C in air; +1 °C to +70 °C in water
Materiāls	Acetalpolymerisat (POM)
Blīvēšanas materiāls	NBR

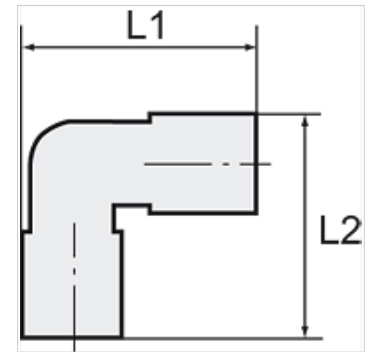

Norāde

Citi dati pieejami pēc pieprasījuma.

Apraksts

Lightweight, push-in fittings distinguished by high strength, toughness, resistance to abrasion and impact resistance - ideal for a wide range of applications. Plastic and metal tubes are connected together quickly and easily. Suitable for compressed air or liquids, with good resistance to a large number of chemicals.

Izstrādājums

Apzīmējums	šļūtenes ārējam Ø	L1 (mm)	L2 (mm)	Īscaurule (mm)
K- 07 40 29 02	4 mm	22,8	27,3	4
K- 07 40 29 03	5 mm	22,8	27,3	5
K- 07 40 29 04	6 mm	25,9	30,8	6
K- 07 40 29 05	8 mm	28,4	34,4	8
K- 07 40 29 06	10 mm	32,7	38,8	10
K- 07 40 29 07	12 mm	42,3	48,5	12
K- 07 40 29 08	15 mm	50,7	57,9	15
K- 07 40 29 09	18 mm	54,2	62,1	18