

K-L-STECKVER L DREH MINI

Male elbows, long, swivel type, mini

HANSA FLEX

Īpašības

Darba spiediens	Max. 10 bar, vacuum
Izmantošana	Air, vacuum
Ieteicamās šļūtenes	PU or PA (nylon)
Darba vides	Saspiests gaiss
Standarts	M thread acc. to DIN 13-1, with O-Ring G thread acc. to DIN EN ISO 228-1, with O-Ring R thread acc. to ISO 7-1, thread coating
Temperatūras diapazons	0 °C to +60 °C
Blīvēšanas virsma	O-ring (NBR)
Materiāls	Plastic, Nickel plated brass
Piespiedējgredzens	Plastic

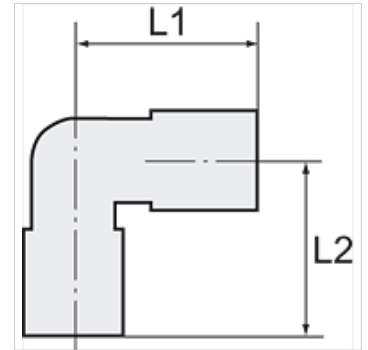

Norāde

Citi dati pieejami pēc pieprasījuma.

Apraksts

Push-in fittings series manufactured in plastic and nickel-plated brass, space-saving miniature design.

Izstrādājums

Apzīmējums	Vītnes	šļūtenes ārējais Ø	L1 (mm)	L2 (mm)	SW
K- 07 40 23 53	M 3	3 mm	12,0	24,0	8 mm
K- 07 40 23 54	M 3	4 mm	14,0	29,2	8 mm
K- 07 40 23 55	M 5	3 mm	12,0	24,0	8 mm
K- 07 40 23 56	M 5	4 mm	14,0	29,2	8 mm
K- 07 40 23 57	M 5	6 mm	16,0	29,2	8 mm
K- 07 40 23 58	M 6	3 mm	12,0	24,5	10 mm
K- 07 40 23 59	M 6	4 mm	14,0	29,6	10 mm
K- 07 40 23 60	M 6	6 mm	16,0	29,6	10 mm
K- 07 40 23 61	G 1/8	4 mm	14,0	28,5	14 mm
K- 07 40 23 62	G 1/8	6 mm	16,0	28,5	14 mm
K- 07 40 23 63	R 1/8	4 mm	14,0	30,0	10 mm
K- 07 40 23 64	R 1/8	6 mm	16,0	30,0	10 mm