

# K-W TUE VB PP

Union elbows

**HANSA FLEX**

## Īpašības

Darba spiediens	on request
Ekspluatācijas temperatūra	Max. +20 °C
Materiāls	Polypropylene (PP)
Bīvēšanas materiāls	NBR

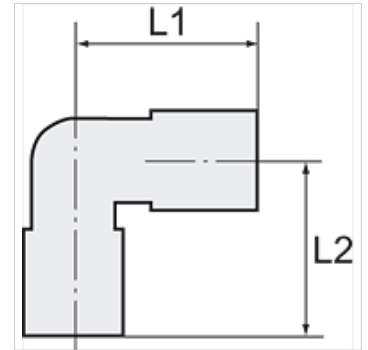

## Norāde

Citi dati pieejami pēc pieprasījuma.

## Apraksts

Lightweight, push-in fittings distinguished by high strength, toughness, resistance to abrasion and impact resistance - ideal for a wide range of applications. Plastic and metal tubes are connected together quickly and easily. Suitable for compressed air or liquids, with good resistance to a large number of chemicals.

## Izstrādājums

Apzīmējums	šļūtenes ārējam Ø	L1 (mm)	L2 (mm)	Īscaurule (mm)
K- 07 40 29 10	32 mm	105,3	96,0	32