

K-L-STECKVER DREH AG OR VA

Male elbows, swivel type, parallel male thread with O-ring

HANSA FLEX

Īpašības

Impulsu darba spiediens	Max. 10 bar
Spiediens	Max. 15 bar (depending on pipe quality)
piemērots caurules materiāls	PVDF, PTFE, stainless steel, PA, PU
Standarts	G thread acc. to DIN EN ISO 228-1, with O-Ring
Vides temperatūra	-20 °C to max. +150 °C (depending on pipe quality and diameter)
Materiāls	Nerūsējošais tērauds 1.4404
Blīvēšanas materiāls	FKM

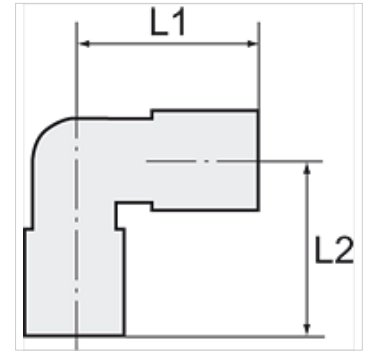
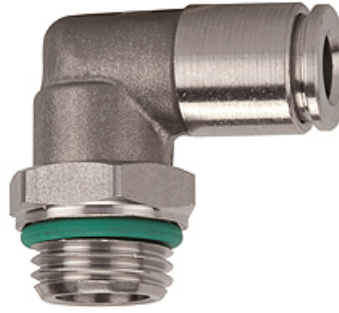

Norāde

Citi dati pieejami pēc pieprasījuma.

Apraksts

For use with aggressive media and in areas with corrosive outside influences, in the food processing industry and in hygienic and sanitary applications.

Izstrādājums

Apzīmējums	Vītnes	šļūtenes ārējais Ø	L1 (mm)	L2 (mm)	SW
K- 07 40 46 76	M 5	4 mm	17,0	14,0	9 mm
K- 07 40 23 91	G 1/8	4 mm	17,0	16,0	13 mm
K- 07 40 23 93	G 1/8	8 mm	22,0	18,0	13 mm
K- 07 40 23 92	G 1/8	6 mm	21,5	18,0	13 mm
K- 07 40 23 89	G 1/4	6 mm	21,5	20,0	16 mm
K- 07 40 23 90	G 1/4	8 mm	22,0	20,0	16 mm
K- 07 40 23 88	G 1/4	10 mm	25,5	22,5	16 mm
K- 07 40 23 94	G 3/8	10 mm	25,5	24,0	21 mm
K- 07 40 23 95	G 3/8	12 mm	28,0	26,5	21 mm
K- 07 40 23 87	G 1/2	12 mm	28,0	31,0	22 mm