

# K-DRV STECK

Unidirectional flow control valves with plug connection, straight type

**HANSA FLEX**

## Īpašības

<b>Darba spiediens</b>	Max. 15 bar, coarse vacuum
<b>Izmantošana</b>	Air, vacuum
<b>Ieteicamās šļūtenes</b>	PU or PA (nylon)
<b>Darba vides</b>	Compressed air and all gases or liquids that are compatible with the materials
<b>Temperatūras diapazons</b>	-20 °C to +80 °C
<b>Blīvēšanas virsma</b>	Parallel version: O-ring in housing, Conical version: thread coating
<b>Materiāls</b>	Plastic, Nickel plated brass
<b>Piespiedējgredzens</b>	Plastic

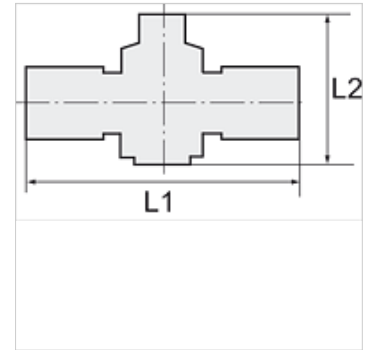
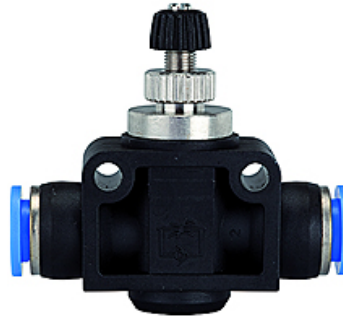

## Norāde

Citi dati pieejami pēc pieprasījuma.

## Apraksts

Push-in fittings series manufactured in plastic and nickel-plated brass. All parts are suitable for use with hoses, tubes or pipes made of plastic and copper.

## Izstrādājums

Apzīmējums	šļūtenes ārējais Ø	L1 (mm)	L2 min (mm)	L2 maks (mm)
K- 07 40 06 76	4 mm	39,5	28,3	30,8
K- 07 40 06 77	6 mm	47,1	41,0	47,2
K- 07 40 06 78	8 mm	52,0	44,4	51,5
K- 07 40 06 79	10 mm	62,3	48,0	55,0
K- 07 40 06 80	12 mm	73,6	52,3	57,7