

# K-DRV AG-K STECK SCHL GEW

Unidirectional flow control valves with parallel male thread and plug connection, straight type, air restriction from tube to port

**HANSA FLEX**

## Īpašības

<b>Darba spiediens</b>	Max. 15 bar, coarse vacuum
<b>Izmantošana</b>	Air, vacuum
<b>Ieteicamās šļūtenes</b>	PU or PA (nylon)
<b>Darba vides</b>	Compressed air and all gases or liquids that are compatible with the materials
<b>Temperatūras diapazons</b>	-20 °C to +80 °C
<b>Bļivēšanas virsma</b>	Parallel version: O-ring in housing, Conical version: thread coating
<b>Materiāls</b>	Plastic, Nickel plated brass
<b>Piespiedējgredzens</b>	Plastic

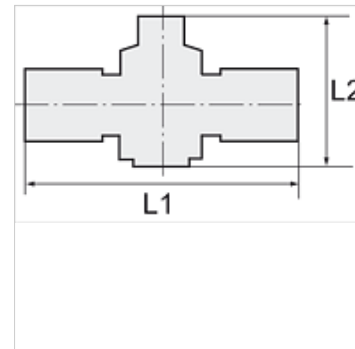

## Norāde

Citi dati pieejami pēc pieprasījuma.

## Apraksts

Push-in fittings series manufactured in plastic and nickel-plated brass. All parts are suitable for use with hoses, tubes or pipes made of plastic and copper.

## Izstrādājums

Apzīmējums	Vītnes	šļūtenes ārējam Ø	L1 (mm)	L2 min (mm)	L2 maks (mm)	SW
K- 07 40 06 99	G 1/8	4 mm	46,5	28,9	31,2	12 mm
K- 07 40 07 00	G 1/8	6 mm	53,7	41,1	46,8	14 mm
K- 07 40 07 01	G 1/8	8 mm	58,1	41,7	47,4	14 mm
K- 07 40 06 97	G 1/4	6 mm	55,1	40,8	47,0	14 mm
K- 07 40 06 98	G 1/4	8 mm	59,6	44,8	50,8	17 mm
K- 07 40 06 95	G 1/4	10 mm	70,3	47,4	54,0	17 mm
K- 07 40 06 96	G 1/4	12 mm	80,6	50,3	55,3	21 mm
K- 07 40 07 04	G 3/8	8 mm	61,0	44,3	50,4	17 mm
K- 07 40 07 02	G 3/8	10 mm	71,6	48,5	55,3	20 mm
K- 07 40 07 03	G 3/8	12 mm	81,3	51,8	57,1	21 mm
K- 07 40 06 93	G 1/2	10 mm	76,0	48,3	54,5	19 mm
K- 07 40 06 94	G 1/2	12 mm	85,9	51,5	56,8	24 mm