

### Eigenschappen

|                      |                                   |
|----------------------|-----------------------------------|
| Aansluiting 1        | Metrische buitendraad cilindrisch |
| Afdichtingsvorm 1    | Vorm B                            |
| Aansluiting 2        | Metrische buitendraad cilindrisch |
| Afdichtingsvorm 2    | 24° binnenconus                   |
| Constructie          | Inschroefverbinding               |
| Uitvoering           | recht                             |
| Norm                 | DIN 2353<br>ISO 8434-1            |
| Leveromvang          | Sok met wartelmoer en snijring    |
| Materiaal            | Staal                             |
| Oppervlakbescherming | Galvanisch gecoat                 |

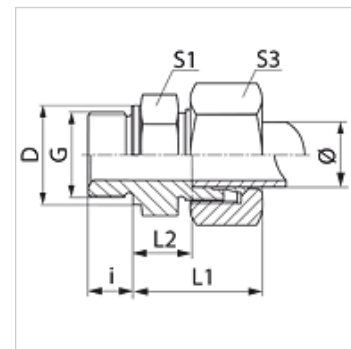

### Aanwijzing

Aanwijzingen voor de montage, inbouw, drukbelasting en toegestane werktemperaturen staan in de technische informatie voor schroefdraadpijpvverbindingen.

### Artikel

| Aanduiding         | Serie | Werkdruk bar | Uitw. Ø buis (mm) | G          | D (mm) | i (mm) | L1 (mm) | L2 (mm) | S1 | S3 |
|--------------------|-------|--------------|-------------------|------------|--------|--------|---------|---------|----|----|
| VM 16 LL           | LL    | PN 100       | 16                | M 22 x 1,5 | 27     | 14     | 44,0    | 15,0    | 27 | 27 |
| VM 16 LL 16-1.5    | LL    | PN 100       | 16                | M 16 x 1,5 | 21     | 12     | 40,5    | 13,5    | 24 | 27 |
| VM 16 LL 18-1.5    | LL    | PN 100       | 16                | M 18 x 1,5 | 23     | 12     | 40,5    | 13,5    | 24 | 27 |
| VM NW 04 HL        | L     | PN 315       | 6                 | M 10 x 1   | 14     | 8      | 23,0    | 8,5     | 14 | 14 |
| VM NW 04 HL 12     | L     | PN 315       | 6                 | M 12 x 1,5 | 17     | 12     | 25,0    | 10,0    | 17 | 14 |
| VM NW 04 HL 14     | L     | PN 315       | 6                 | M 14 x 1,5 | 19     | 12     | 25,0    | 10,0    | 19 | 14 |
| VM NW 04 HL 16     | L     | PN 315       | 6                 | M 16 x 1,5 | 21     | 12     | 25,0    | 11,5    | 22 | 14 |
| VM NW 04 HL 18     | L     | PN 315       | 6                 | M 18 x 1,5 | 23     | 12     | 24,5    | 11,5    | 24 | 14 |
| VM NW 04 HL 22     | L     | PN 315       | 6                 | M 22 x 1,5 | 27     | 14     | 28,0    | 13,0    | 27 | 14 |
| VM NW 06 HL        | L     | PN 315       | 8                 | M 12 x 1,5 | 17     | 12     | 25,0    | 10,0    | 17 | 17 |
| VM NW 06 HL 10     | L     | PN 315       | 8                 | M 10 x 1   | 17     | 8      | 25,0    | 10,0    | 17 | 17 |
| VM NW 06 HL 14     | L     | PN 315       | 8                 | M 14 x 1,5 | 19     | 12     | 25,0    | 10,0    | 19 | 17 |
| VM NW 06 HL 16     | L     | PN 315       | 8                 | M 16 x 1,5 | 21     | 12     | 26,0    | 11,5    | 22 | 17 |
| VM NW 06 HL 18     | L     | PN 315       | 8                 | M 18 x 1,5 | 23     | 12     | 26,0    | 11,5    | 24 | 17 |
| VM NW 06 HL 22     | L     | PN 315       | 8                 | M 22 x 1,5 | 27     | 14     | 28,0    | 13,0    | 27 | 17 |
| VM NW 08 HL        | L     | PN 315       | 10                | M 14 x 1,5 | 19     | 12     | 26,0    | 11,0    | 19 | 19 |
| VM NW 08 HL 12     | L     | PN 315       | 10                | M 12 x 1,5 | 17     | 12     | 26,0    | 11,0    | 17 | 19 |
| VM NW 08 HL 16     | L     | PN 315       | 10                | M 16 x 1,5 | 22     | 12     | 27,5    | 12,5    | 22 | 19 |
| VM NW 08 HL 18     | L     | PN 315       | 10                | M 18 x 1,5 | 23     | 12     | 27,5    | 12,5    | 24 | 19 |
| VM NW 08 HL 22     | L     | PN 315       | 10                | M 22 x 1,5 | 27     | 14     | 29,0    | 14,0    | 27 | 19 |
| VM NW 10 HL        | L     | PN 315       | 12                | M 16 x 1,5 | 21     | 12     | 27,0    | 12,5    | 22 | 22 |
| VM NW 10 HL 12     | L     | PN 315       | 12                | M 12 x 1,5 | 17     | 12     | 26,0    | 11,0    | 19 | 22 |
| VM NW 10 HL 14     | L     | PN 315       | 12                | M 14 x 1,5 | 19     | 12     | 27,0    | 12,5    | 22 | 22 |
| VM NW 10 HL 18     | L     | PN 315       | 12                | M 18 x 1,5 | 23     | 12     | 27,0    | 12,5    | 24 | 22 |
| VM NW 10 HL 22     | L     | PN 315       | 12                | M 22 x 1,5 | 27     | 14     | 28,5    | 14,0    | 27 | 22 |
| VM NW 10 HL 24     | L     | PN 315       | 12                | M 24 x 1,5 | 27     | 14     | 28,5    | 14,0    | 27 | 22 |
| VM NW 10 HL 26     | L     | PN 315       | 12                | M 26 x 1,5 | 27     | 14     | 28,5    | 14,0    | 27 | 22 |
| VM NW 13 HL        | L     | PN 315       | 15                | M 18 x 1,5 | 23     | 12     | 29,0    | 13,5    | 24 | 27 |
| VM NW 13 HL 14     | L     | PN 315       | 15                | M 14 x 1,5 | 19     | 12     | 29,0    | 13,5    | 24 | 27 |
| VM NW 13 HL 16     | L     | PN 315       | 15                | M 16 x 1,5 | 21     | 12     | 29,0    | 13,5    | 24 | 27 |
| VM NW 13 HL 22     | L     | PN 315       | 15                | M 22 x 1,5 | 27     | 14     | 30,5    | 15,0    | 27 | 27 |
| VM NW 13 HL 26     | L     | PN 315       | 15                | M 26 x 1,5 | 31     | 16     | 30,5    | 15,0    | 32 | 27 |
| VM NW 13 HL 30     | L     | PN 315       | 15                | M 30 x 2   | 39     | 16     | 30,5    | 15,0    | 41 | 27 |
| VM NW 16 HL        | L     | PN 315       | 18                | M 22 x 1,5 | 27     | 14     | 31,0    | 14,5    | 27 | 32 |
| VM NW 16 HL 18     | L     | PN 315       | 18                | M 18 x 1,5 | 23     | 12     | 30,5    | 14,0    | 27 | 32 |
| VM NW 16 HL 26     | L     | PN 315       | 18                | M 26 x 1,5 | 31     | 16     | 31,0    | 14,5    | 32 | 32 |
| VM NW 16 HL 27     | L     | PN 315       | 18                | M 27 x 2   | 31     | 16     | 31,0    | 14,5    | 32 | 32 |
| VM NW 16 HL 30-1.5 | L     | PN 315       | 18                | M 30 x 1,5 | 39     | 16     | 31,0    | 15,0    | 41 | 27 |
| VM NW 20 HL        | L     | PN 160       | 22                | M 26 x 1,5 | 31     | 16     | 33,0    | 16,5    | 32 | 36 |
| VM NW 20 HL 18     | L     | PN 160       | 22                | M 18 x 1,5 | 27     | 14     | 31,0    | 14,5    | 27 | 36 |
| VM NW 20 HL 22     | L     | PN 160       | 22                | M 22 x 1,5 | 27     | 14     | 33,0    | 16,5    | 32 | 36 |



Artikel

| Aanduiding         | Serie | Werkdruk bar | Uitw. Ø buis (mm) | G          | D (mm) | i (mm) | L1 (mm) | L2 (mm) | S1 | S3 |
|--------------------|-------|--------------|-------------------|------------|--------|--------|---------|---------|----|----|
| VM NW 20 HL 30-1.5 | L     | PN 160       | 22                | M 30 x 1,5 | 39     | 14     | 33,0    | 16,5    | 41 | 36 |
| VM NW 25 HL        | L     | PN 160       | 28                | M 33 x 2   | 39     | 18     | 34,0    | 17,5    | 41 | 41 |
| VM NW 25 HL 22     | L     | PN 160       | 28                | M 22 x 1,5 | 27     | 18     | 34,0    | 17,5    | 32 | 41 |
| VM NW 25 HL 26     | L     | PN 160       | 28                | M 26 x 1,5 | 31     | 16     | 34,0    | 17,5    | 41 | 41 |
| VM NW 25 HL 27     | L     | PN 160       | 28                | M 27 x 2   | 39     | 20     | 34,0    | 17,5    | 41 | 41 |
| VM NW 25 HL 42     | L     | PN 160       | 28                | M 42 x 2   | 55     | 22     | 34,0    | 19,0    | 55 | 41 |
| VM NW 32 HL        | L     | PN 160       | 35                | M 42 x 2   | 49     | 20     | 39,0    | 17,5    | 50 | 50 |
| VM NW 40 HL        | L     | PN 160       | 42                | M 48 x 2   | 55     | 22     | 42,0    | 19,0    | 55 | 60 |
| VM NW 03 HS        | S     | PN 400       | 6                 | M 12 x 1,5 | 17     | 12     | 28,0    | 13,0    | 17 | 17 |
| VM NW 03 HS 16     | S     | PN 400       | 6                 | M 16 x 1,5 | 21     | 12     | 28,0    | 13,0    | 17 | 17 |
| VM NW 03 HS 18     | S     | PN 400       | 6                 | M 18 x 1,5 | 27     | 14     | 28,0    | 13,0    | 19 | 17 |
| VM NW 03 HS 22     | S     | PN 400       | 6                 | M 22 x 1,5 | 25     | 14     | 28,0    | 13,0    | 19 | 17 |
| VM NW 04 HS        | S     | PN 400       | 8                 | M 14 x 1,5 | 19     | 12     | 30,0    | 15,0    | 19 | 19 |
| VM NW 06 HS        | S     | PN 400       | 10                | M 16 x 1,5 | 21     | 12     | 31,0    | 15,0    | 22 | 22 |
| VM NW 06 HS 18     | S     | PN 400       | 10                | M 18 x 1,5 | 27     | 14     | 31,0    | 15,0    | 22 | 22 |
| VM NW 06 HS 22     | S     | PN 400       | 10                | M 22 x 1,5 | 27     | 14     | 31,0    | 15,0    | 24 | 22 |
| VM NW 08 HS        | S     | PN 400       | 12                | M 18 x 1,5 | 23     | 12     | 33,0    | 17,0    | 24 | 24 |
| VM NW 08 HS 14     | S     | PN 400       | 12                | M 14 x 1,5 | 21     | 12     | 33,0    | 17,0    | 19 | 24 |
| VM NW 08 HS 16     | S     | PN 400       | 12                | M 16 x 1,5 | 21     | 12     | 29,0    | 17,0    | 24 | 24 |
| VM NW 08 HS 22     | S     | PN 400       | 12                | M 22 x 1,5 | 27     | 14     | 33,5    | 17,5    | 27 | 24 |
| VM NW 10 HS        | S     | PN 400       | 14                | M 20 x 1,5 | 25     | 14     | 37,0    | 19,0    | 27 | 27 |
| VM NW 10 HS 16     | S     | PN 400       | 14                | M 16 x 1,5 | 21     | 12     | 37,0    | 19,0    | 24 | 27 |
| VM NW 10 HS 18     | S     | PN 400       | 14                | M 18 x 1,5 | 27     | 14     | 37,0    | 19,0    | 24 | 27 |
| VM NW 10 HS 22     | S     | PN 400       | 14                | M 22 x 1,5 | 27     | 14     | 37,0    | 19,0    | 27 | 27 |
| VM NW 13 HS        | S     | PN 400       | 16                | M 22 x 1,5 | 27     | 14     | 37,0    | 18,5    | 27 | 30 |
| VM NW 13 HS 16     | S     | PN 400       | 16                | M 16 x 1,5 | 21     | 12     | 37,0    | 18,5    | 24 | 30 |
| VM NW 13 HS 18     | S     | PN 400       | 16                | M 18 x 1,5 | 23     | 12     | 37,0    | 18,5    | 27 | 30 |
| VM NW 13 HS 26     | S     | PN 400       | 16                | M 26 x 1,5 | 32     | 16     | 37,0    | 18,5    | 32 | 30 |
| VM NW 16 HS        | S     | PN 400       | 20                | M 27 x 2   | 32     | 16     | 42,0    | 20,5    | 32 | 36 |
| VM NW 16 HS 22     | S     | PN 400       | 20                | M 22 x 1,5 | 27     | 14     | 42,0    | 20,5    | 32 | 36 |
| VM NW 16 HS 30-1.5 | S     | PN 400       | 20                | M 30 x 1,5 | 39     | 18     | 42,0    | 20,5    | 36 | 36 |
| VM NW 20 HS        | S     | PN 250       | 25                | M 33 x 2   | 39     | 18     | 47,0    | 23,0    | 41 | 46 |
| VM NW 20 HS 27     | S     | PN 250       | 25                | M 27 x 2   | 32     | 16     | 47,0    | 23,0    | 41 | 46 |
| VM NW 25 HS        | S     | PN 160       | 30                | M 42 x 2   | 49     | 20     | 50,0    | 23,5    | 50 | 50 |
| VM NW 32 HS        | S     | PN 160       | 38                | M 48 x 2   | 55     | 22     | 57,0    | 26,0    | 55 | 60 |

Serie: LL = zeer licht L = licht S = zwaar - PN = nominale druk PB = max. werkdruk - Ø = buis-buitendiameter

Productvarianten

|       |                              |
|-------|------------------------------|
| VM MG | Inschroefverbinding, Messing |
| VM VA | Inschroefverbinding, RVS     |
| XVM   | Inschroefverbinding, Staal   |