

# K-SCHL-AUFROLLER LU WA L

Hose reels for compressed air and water, lightweight type

**HANSA FLEX**

## Eigenschappen

<b>Materiaal slang</b>	PVC
<b>Werkdruk</b>	max. 12 bar (K-07100622); max. 20 bar (K-07100623)
<b>Bedrijfstemperatuur</b>	max. +60 °C
<b>Ingangsmof</b>	G 1/4
<b>Zwenkhoek</b>	180°

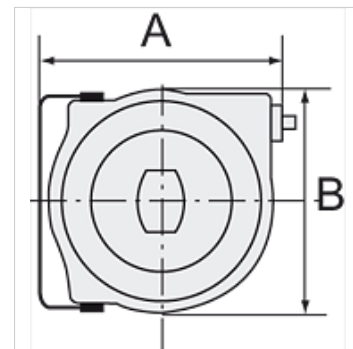

## Aanwijzing

Andere gegevens op aanvraag.

## Beschrijving

High-quality, impact-resistant polypropylene housing. An automatic latching mechanism allows the hose to be engaged at any length. Enclosed spring. Precise locking device for continuous feeding or stop function. Reel guide prevents excessive wear on the hose.

## Artikel

Aanduiding	Slangmaat	A (mm)	B (mm)	Lengte slang (m)
K- 07 10 06 22	12 mm x 8 mm	340,0	311,0	8
K- 07 10 06 23	12 mm x 6 mm	445,0	400,0	15