

K-DRS ELK GERAETESTECKER

Pressure switches, connection with plug connector, type A acc. to DIN 43650

HANSA FLEX

Eigenschappen

Toepassingsgebied	Pneumatic applications
Schakelfrequentie	200/min.
Schakelspanning	max. 250 V AC / 28 V DC
Beschermingsklasse	IP 65 (DIN 43650), IP 67 (M 12 x 1)
Temperatuurgebied	-10 °C to +80 °C
Instelkap	Aluminium, powder-coated
Behuizing	Special die-cast material
Membranen, afdichting	NBR

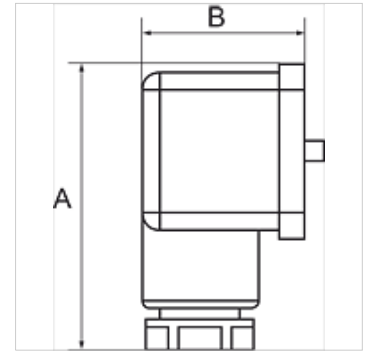

Aanwijzing

Andere gegevens op aanvraag.

Beschrijving

For converting pneumatic to electrical signals. Designed for use in rough vacuum applications (technical vacuum). Universal switch type, suitable as NC, NO or changeover contact. These devices are free from paint-wetting impairment substances (PWIS).

Artikel

Aanduiding	Aansluiting	Instelbereik	A (mm)	B (mm)
K- 07 30 28 45	G 1/4	0,2 - 2,0 bar	48,0	28,0
K- 07 30 28 46	G 1/4	0,5 - 8,0 bar	48,0	28,0
K- 07 30 28 47	G 1/4	1,0 - 16,0 bar	48,0	28,0