

# K-DRS ELK ANSCHLUSS M 1

Pressure switches, electrical connection M 12 x 1

## Eigenschappen

<b>Toepassingsgebied</b>	Pneumatic applications
<b>Schakelfrequentie</b>	200/min.
<b>Schakelspanning</b>	max. 250 V AC / 28 V DC
<b>Beschermingsklasse</b>	IP 65 (DIN 43650), IP 67 (M 12 x 1)
<b>Temperatuurgebied</b>	-10 °C to +80 °C
<b>Instelkap</b>	Aluminium, powder-coated
<b>Behuizing</b>	Special die-cast material
<b>Membranen, afdichting</b>	NBR

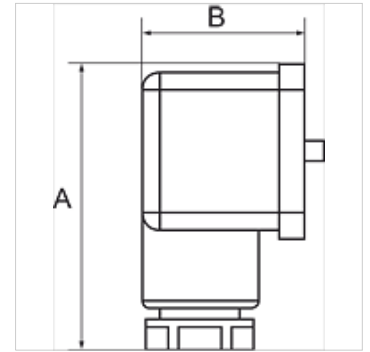

## Aanwijzing

Andere gegevens op aanvraag.

## Beschrijving

For converting pneumatic to electrical signals. Designed for use in rough vacuum applications (technical vacuum). Universal switch type, suitable as NC, NO or changeover contact. These devices are free from paint-wetting impairment substances (PWIS).

## Artikel

Aanduiding	Aansluiting	Instelbereik	A (mm)	B (mm)
K- 07 30 28 48	G 1/4	0,2 - 2,0 bar	48,0	28,0
K- 07 30 28 49	G 1/4	0,5 - 8,0 bar	48,0	28,0
K- 07 30 28 50	G 1/4	1,0 - 16,0 bar	48,0	28,0