

# K-DRS ELK GERAETESTECKER VAKUUM

Pressure switches, connection with plug connector, type A acc. to DIN 43650

**HANSA FLEX**

## Eigenschappen

<b>Toepassingsgebied</b>	Pneumatic applications
<b>Schakelfrequentie</b>	200/min.
<b>Schakelspanning</b>	max. 250 V AC / 28 V DC
<b>Instelbereik</b>	-0.85 / +1 bar
<b>Beschermingsklasse</b>	IP 65 (DIN 43650), IP 67 (M 12 x 1)
<b>Temperatuurgebied</b>	-10 °C to +80 °C
<b>Instelkap</b>	Aluminium, powder-coated
<b>Behuizing</b>	Special die-cast material
<b>Membranen, afdichting</b>	Perbunan

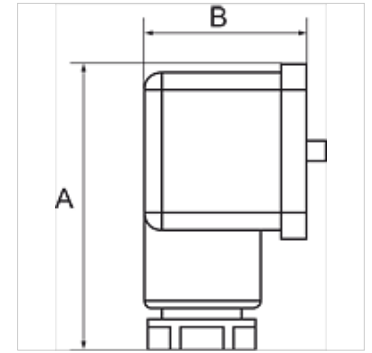

## Aanwijzing

Andere gegevens op aanvraag.

## Beschrijving

For converting pneumatic to electrical signals. Designed for use in rough vacuum applications (technical vacuum). Universal switch type, suitable as NC, NO or changeover contact. These devices are free from paint-wetting impairment substances (PWIS).

## Artikel

Aanduiding	Aansluiting	A (mm)	B (mm)
K- 07 30 28 51	Flens	48,0	28,0
K- 07 30 28 53	G 1/4	48,0	28,0