

K-DRS ELK ANSCHLUSS M VAKUUM

Pressure switches, electrical connection M 12 x 1

HANSA FLEX

Eigenschappen

Toepassingsgebied	Pneumatic applications
Schakelfrequentie	200/min.
Schakelspanning	max. 250 V AC / 28 V DC
Instelbereik	-0.85 / +1 bar
Beschermingsklasse	IP 65 (DIN 43650), IP 67 (M 12 x 1)
Temperatuurgebied	-10 °C to +80 °C
Instelkap	Aluminium, powder-coated
Behuizing	Special die-cast material
Membranen, afdichting	Perbunan

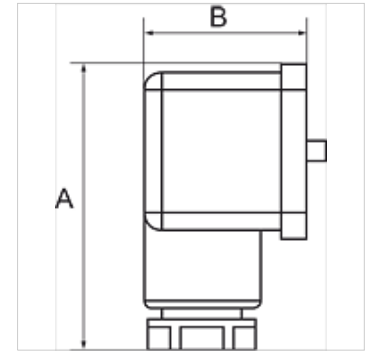

Aanwijzing

Andere gegevens op aanvraag.

Beschrijving

For converting pneumatic to electrical signals. Designed for use in rough vacuum applications (technical vacuum). Universal switch type, suitable as NC, NO or changeover contact. These devices are free from paint-wetting impairment substances (PWIS).

Artikel

Aanduiding	Aansluiting	A (mm)	B (mm)
K- 07 30 28 52	Flens	48,0	28,0
K- 07 30 28 54	G 1/4	48,0	28,0